

Spot Leak Detectors

Spot Leak Detectors

FEATURES

- Simple installation – screw, or ram-set to floor (SD, SD-R01, SD-Z)
- Simple operation – no maintenance
- Solid-state design...no moving parts to fail
- SD, SD-R01, SD-Z models have polymer-coated sensing probes...no exposed metal that will rust
- All models are fully potted for water-proofing...maximum durability

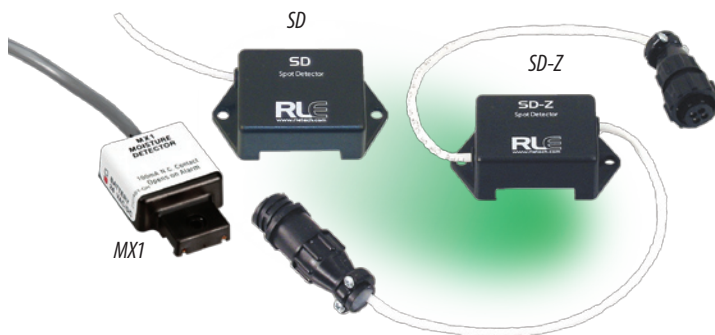

MODEL	DESCRIPTION
SD Spot Detector	<ul style="list-style-type: none"> ■ Operates on either 12-36VAC or 18-36VDC power ■ Includes a 14ft (4.2m) leader cable
SD-R01 Spot Detector with Relay Output	<ul style="list-style-type: none"> ■ Works with any system that accepts dry contacts ■ Operates on 24VAC/VDC±10% ■ Automatically resets when conductive fluid is no longer present (AC power only; if DC power is used, device must be reset by disconnecting power momentarily) ■ Includes a 14ft (4.2m) leader cable
SD-Z Spot Detector	<ul style="list-style-type: none"> ■ Designed for use with the all detection panels, with SC sensing cable to integrate both zone and spot detection into one panel ■ Powered by the LD300, LD1000, LD5100, LDRA6, or LD2000 ■ When used with a distance read panel (LD2000 or OD5100), the location of the leak will be identified (simulates 50 feet) ■ Includes one male and one female end connector, each on a 1ft (30cm) lead wire
MX1 Spot Detector	<ul style="list-style-type: none"> ■ Battery-operated or 12-30VDC/24VAC powered

DESCRIPTION

SD, SD-R01, SD-Z and MX1 Spot Detectors detect conductive fluids at a single point for the most economical way to detect fluids in small, confined areas. These devices are commonly used in small rooms and in air-conditioning drip pans.

Veris offers four models of spot detectors which can integrate with various building management systems.

LEAK DETECTION

SPECIFICATIONS (SD, SD-R01, SD-Z)

Input Power (SD-R01 Only)	24VAC/VDC ± 10%; 0.1A max.
<i>Outputs:</i>	
Solid-state (SD Only)	12-36VAC @ 0.01A min., 0.1A max.; 18-36VDC @ 0.01A min., 0.1A max.
Relay (SD-R01 Only)	Dry Contact, Form C; 1A @ 24VDC, 0.5A resistive @ 120VAC
<i>Leader Cable (NSC):</i>	
Length	SD: 14 Ft. (4.2m), SD-R01: 14 Ft. (4.2m), SD-Z: 10" (0.3m) (2 cables included)
Connector (SD-Z Only):	1 male, 1 female; 4 pin, 0.96" (24.38mm) diameter; connects to SC, or NSC Cable
<i>Operating Environment:</i>	
Temperature	0° to 50°C (32° to 122°F)
Humidity	5% to 95% RH, non-condensing
Altitude	10,000 Ft. (3,048m) max.
Storage Environment	-20° to 70°C (-4° to 158°F)

SPECIFICATIONS (MX1)

Input Power	12-30VDC/24VAC; 10-year lithium battery model available
Max Current Draw, Voltage Units Only	10mA
Output	N.C. solid-state, (opens on alarm)
Output Rating	30VAC/DC @ 0.1A max., polarity insensitive
Sensing Electrodes	Gold plated
<i>Operating Environment:</i>	
Temperature	-20° to 80°C (-4° to 176°F)
Humidity	0 to 100% RH

APPLICATION/WIRING DIAGRAMS

DIMENSIONAL DRAWINGS

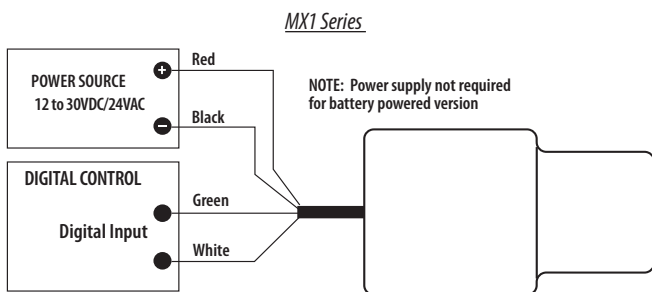
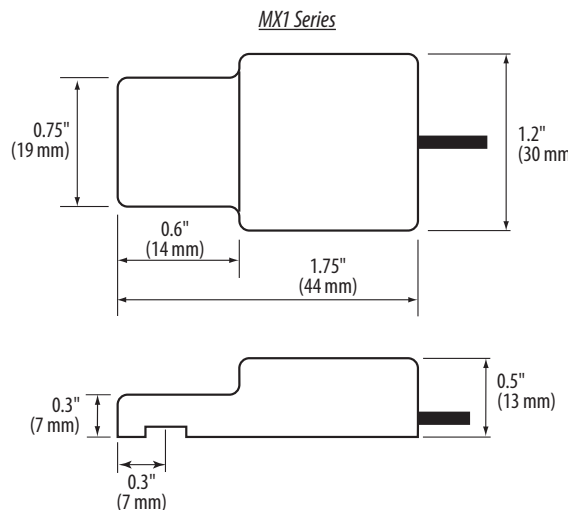
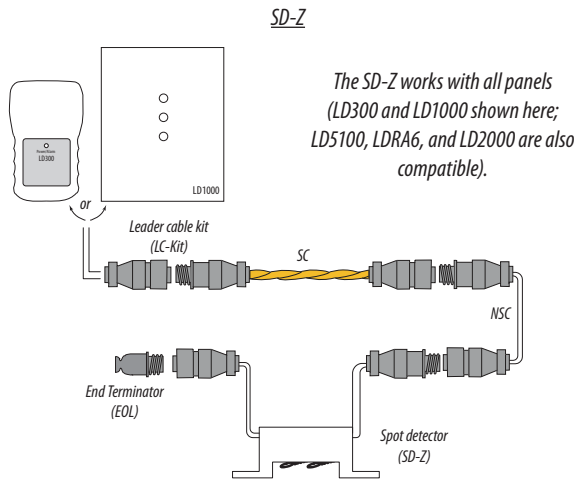
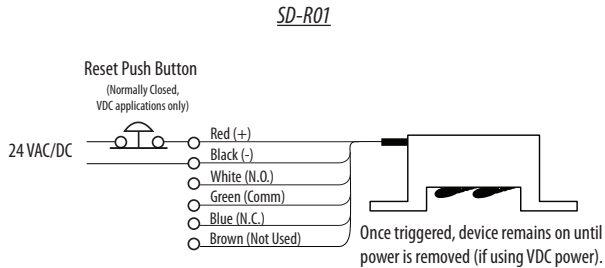
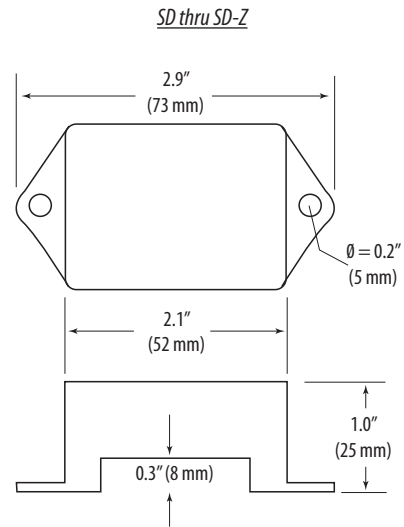
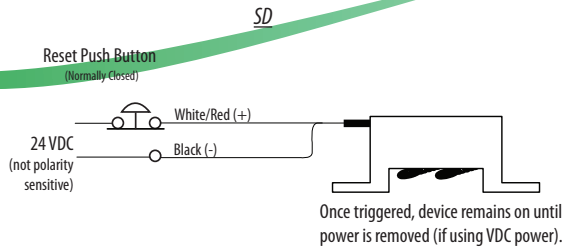

ORDERING INFORMATION

MODEL	MANUF. PART #	DESCRIPTION	CE	RoHS	ETL
U006-0006	SD	Spot Detector, 14' leader cable	●	●	●
U006-0007	SD-R01	Spot Detector, 14' leader cable, relay out	●	●	●
U006-0008	SD-Z	Spot Detector, 2x10" leader cable	●	●	●
MX1B	MX1B	Spot Detector, battery			
MX1V	MX1V	Spot Detector, 12-30VDC/24VAC			