









ACCOMPANIMENT

-  ×4
(Screw: 8-36 THR'D 0.21inch deep)
-  ×4
(Screw: 8-36 THR'D 0.5inch deep)
-  ×4 
(Screw: 8-36 THR'D 0.625inch deep)
-  ×1 
(UR: 3M Connector)

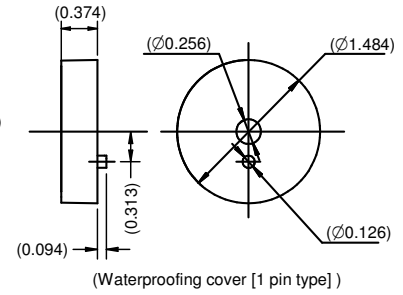

(Waterproofing cover [1 pin type])

CATALOG EC5414E
NIDEC SERVO CORPORATION
AC115V-AC230V 1550/1650 RPM
0.22-0.75A/0.15-0.45A 4-25W
REVERSIBLE -40°C~55°C AMB
CLASS A FP8S20U-914
60Hz IP67
 **AO EP**
E469727
MADE IN CHINA

DATE CODE

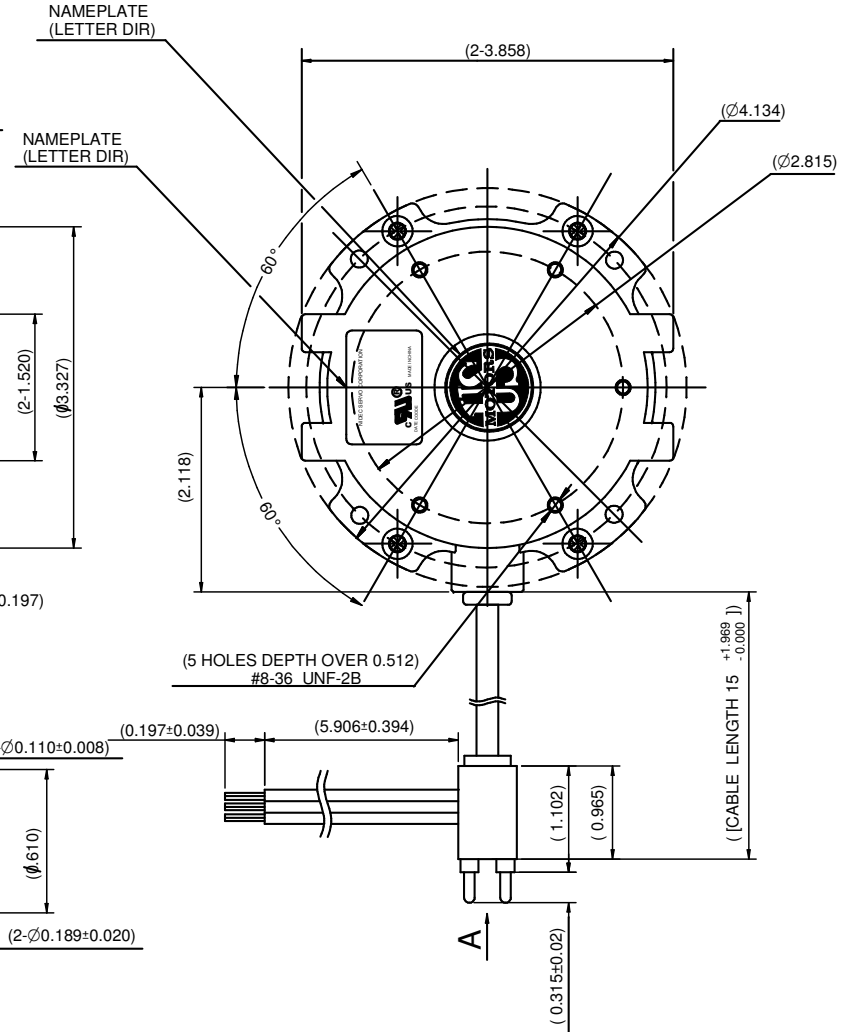
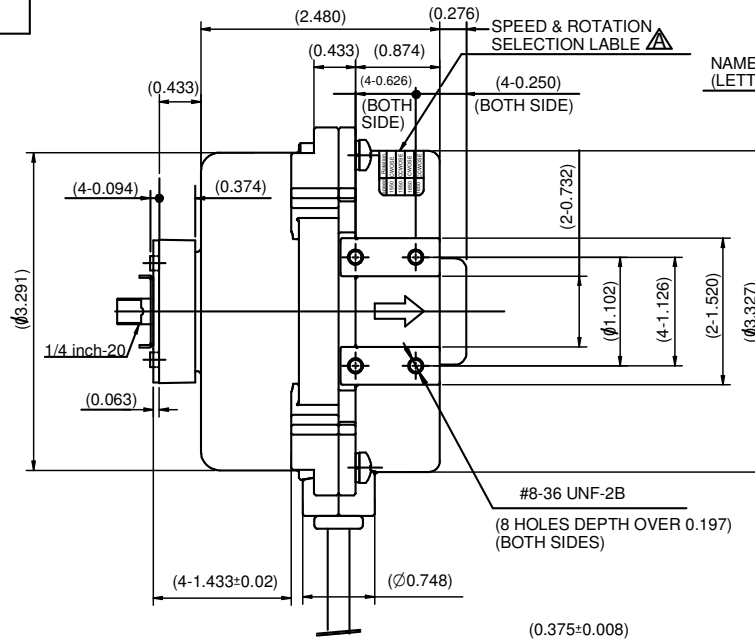
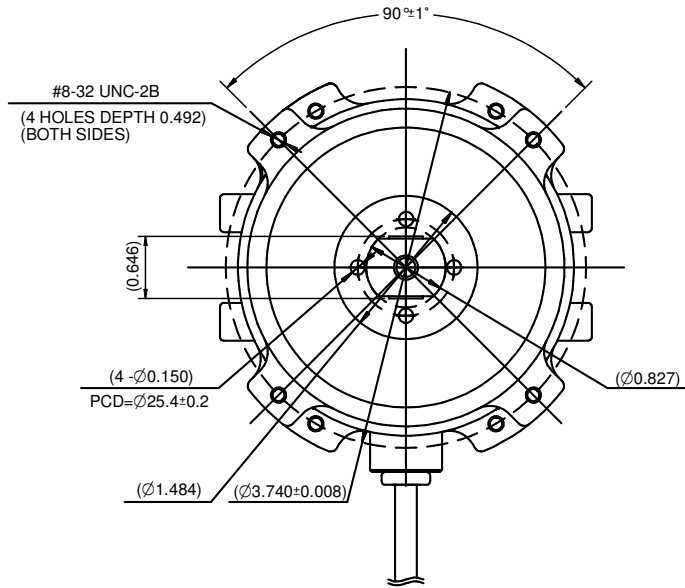

CONNECTION GUIDE

PIN No.	COLOR	NAME	LEAD TYPE
1	BLACK	GND	UL2517
2	RED	SPEED	
3	BLUE	ROTATION	

SPEED & ROTATION SELECTION LABEL 

speed	Rotation	wire color combinations		
1550	CWOSE	--	--	--
1550	CCWOSE	--	Blue	Black
1650	CWOSE	Red	--	--
1650	CCWOSE	Red	Blue	--

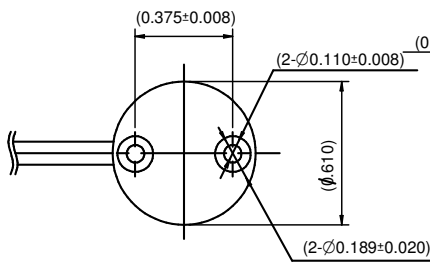

SHEET NUMBER	REV	REVISION RECORD FOR: ECO E26842		
1 OF 1	--	CREATED DRAWING.		
REVISION DATE		03-OCT-16		
ISSUED BY	G. ISASSI	REVIEWED BY	B. GAITAN	ENGINEER APPROVED
		B. GAITAN		

INFORMATION DISCLOSED ON THIS DOCUMENT IS CONSIDERED PROPRIETARY AND SHALL NOT BE REPRODUCED OR DISCLOSED WITHOUT WRITTEN CONSENT OF NIDEC MOTOR CORPORATION

NIDEC MOTOR CORPORATION

ALL DIMENSIONS ARE FOR REFERENCE ONLY UNLESS TOLERANCE IS GIVEN

TITLE	CODE	ITEM NO.	SIZE
ASSEMBLED VIEW	V01	812828	B