

AUTOMATIC THERMAL PROTECTOR

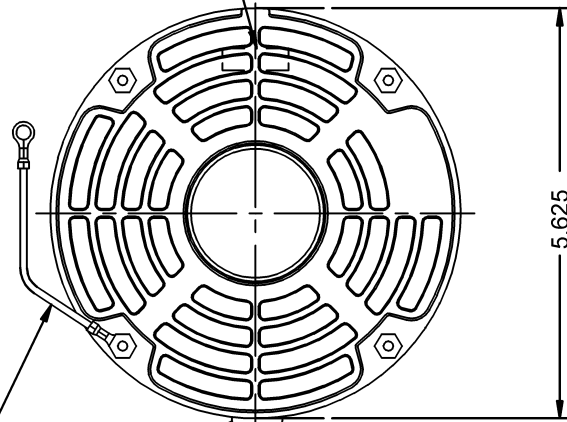

GROMMET

(6) LEADS #18, 2/64 THICK INSUL. TO EXTEND BEYON MOTOR:
 (2)BRN=15.000±1.000,
 WHITE=18.000 +2 -0, BLACK=18.000 +2 -0,
 BLUE=18.000 +2 -0, RED=18.000 +2 -0
 WITH 1/4 INSULATED STRAIGHT Q.C.
 TERMINALS AMP # 521367-2

REV. C

#18 GREEN/YELLOW STRIPES
 GROUND LEAD TO BE 15.000±1.000
 BETWEEN CENTERS OF TERMS.
 TERMINALS TO FIT .250 EYELET

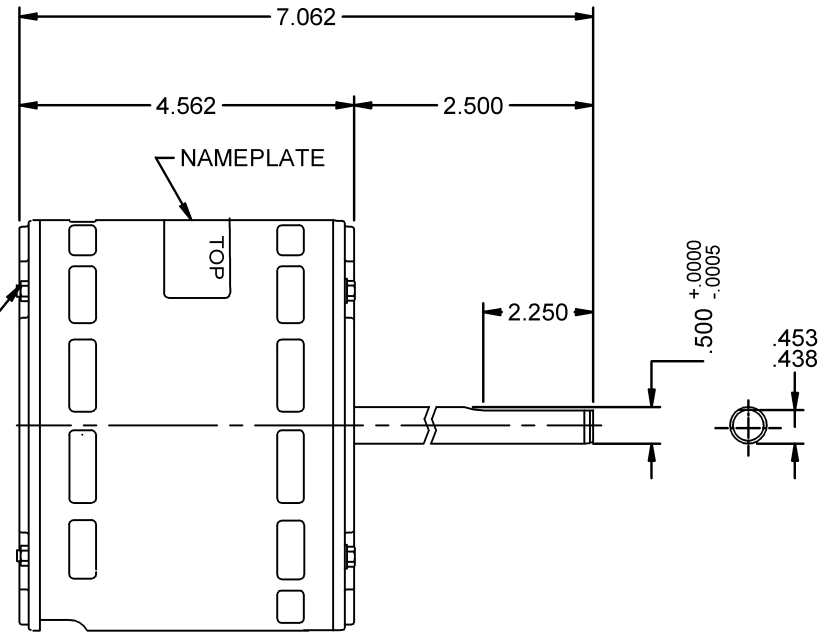

8-32 THR'D

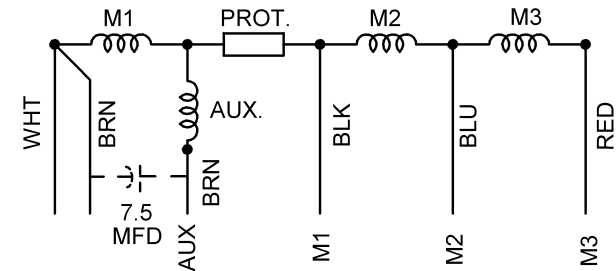

NIDEC MOTOR CORPORATION 20-Sep-12

MODEL	REF	CUSTOMER	HP	VOLTS	AMPS	HZ	RPM	ROTATION	CUSTOMER PN	
K55HXKNA-0129	A31725-X3	WHOLESALE - HAC	1/4	208-230	1.5	60	1075/3 SPD	CW LEAD END	CA3406	
SHEET NUMBER 1 OF 1	REV C	REVISION RECORD FOR: C6376-00			INFORMATION DISCLOSED ON THIS DOCUMENT IS CONSIDERED PROPRIETARY AND SHALL NOT BE REPRODUCED OR DISCLOSED WITHOUT WRITTEN CONSENT OF NIDEC MOTOR CORPORATION				NIDEC MOTOR CORPORATION	
REVISION DATE		DELETED LEAD AN UPDATED NOTE								
20-SEP-12										
ISSUED BY A. SANCHEZ		REVIEWED BY J.I. SALAZAR	ENGINEER APPROVED B. GAITAN		TITLE ASSEMBLED VIEW			CODE V01	ITEM NO. 789279	SIZE A