

# WEISS INSTRUMENTS

Thermometers

Temperature Controllers

Pressure Gauges

HVAC/R Instruments



Throughout the 20th century, the Weiss name has been synonymous with quality and reliability in instrumentation. Some of the products we have manufactured for more than 125 years are proudly illustrated in this catalog, dedicated to your requirements in the air-conditioning, refrigeration and heating industry. Recent products such as our line of Electronic Temperature Controllers, fast becoming the OEM choice, are also available to you.

Whether you require instruments for temperature or pressure monitoring, the Weiss line offers a full range of outstanding products from which to choose. Our commitment to quality extends well beyond the products we provide. Each day we strive to offer our customers responsive service and reliable deliveries, qualities so necessary in today's business climate. Weiss understands the trends of today's market and we look forward to proving our ability to react to the daily challenge.

**THERMOMETERS**

Temperature / Humidity  
 Remote Reading Dial  
 LED Digital  
 Solar Digital  
 Liquid-in-Glass  
 Bimetal Dial  
 Spirit-in-Glass

**PRESSURE GAUGES**

Refrigeration  
 Ammonia  
 Diaphragm  
 Liquid Filled  
 HVAC  
 Triometers  
 Utility

**CONTROLLERS**

Refrigeration/Freezer  
 Medium Temp  
 Low Temp

Quality products, Responsive service, Reliable delivery...Your customers demand it, the Weiss HVAC/R program provides it.

Old World Craftsmanship . . . NEW WORLD TECHNOLOGY  
 Celebrating 125 Years

**INDEX**

<a href="#">Infra-red Thermometers and LED Digital Thermometers</a>	<a href="#">Page 3</a>
<a href="#">Controller and Alarm Kit and Walk-in Alarm &amp; Light Manager</a>	<a href="#">4</a>
<a href="#">Digital Thermometer with Switch Plate</a>	<a href="#">5</a>
<a href="#">Refrigeration/Freezer Controllers</a>	<a href="#">6</a>
<a href="#">Dixell Probes and Accessories</a>	<a href="#">7</a>
<a href="#">Digital Differential Thermometer and Probes</a>	<a href="#">8</a>
<a href="#">Thermo-Anemometer and LCD Remote Reading Digital Thermometers</a>	<a href="#">9</a>
<a href="#">NSF Remote Reading Dial Thermometers</a>	<a href="#">10</a>
<a href="#">Union Connected Dial Thermometers</a>	<a href="#">11</a>
<a href="#">Digital Vari-angle Thermometer</a>	<a href="#">12</a>
<a href="#">Industrial Glass Thermometers and Trade Line</a>	<a href="#">13</a>
<a href="#">Refrigeration Pressure Gauges</a>	<a href="#">14</a>
<a href="#">Ammonia Gauges</a>	<a href="#">15</a>
<a href="#">HVAC Gauges and Tri-o-meters</a>	<a href="#">16</a>
<a href="#">Trade Line Gauges</a>	<a href="#">17</a>
<a href="#">General Purpose and Refrigerator / Freezer Thermometers</a>	<a href="#">18</a>
<a href="#">Temperature Humidity Tester and Compact Thermo / Hygrometer</a>	<a href="#">19</a>



# INFRA - RED THERMOMETERS

This Professional Grade Infra-red Thermometer is one of the most advanced units manufactured today. It's easy to use and applicable for almost any temperature measurement.



IR921

- 9:1 Ratio
- Laser Pointer
- Pistol Grip Design
- Back Light
- 1% Accuracy
- Auto Off

Cat. No.	Range (Switchable)	IDN
IR921	-58/752°F -50/400°C	60206

# LED REMOTE READING DIGITAL THERMOMETERS

Where customers prefer LED, Weiss offers our 2" retrofit unit, the 20DT. Now with 120Vac direct power (no transformer needed) and 1/2" high intensity red readout. All the digital thermometers are NSF listed. Both units feature a 9V DC battery back-up circuit that will display the temperature during a power outage (up to 36 hours).



20DT-F

Series DT - LED					
NSF Model	Cat. No.	Case	Range <sup>1</sup>	Sensor Length <sup>3</sup>	IDN
DT	20DT-F	Front Flange	40/0/230°F	05ft	60520
DT	20DT-U	U-Clamp	40/0/230°F	05ft	60530
DT	24DT* <sup>2</sup>	Back Mount	40/0/230°F	05ft.	60570

NOTES: 1. Equivalent °C available, consult Factory. 2. Features °F/°C switch. 3. Longer line lengths available.

Consult the Factory for 12V, 230V and Battery Back-up Kit.



24DT

# CONTROLLER AND ALARM KIT FOR WALK-INS

If the Compressor is the heart of any Refrigeration System then surely temperature control instrumentation is the brains. And without reliable instruments food quality will suffer and losses will occur. Weiss Instruments/Dixell Controls with extensive experience in the foodservice/refrigeration industry offers the most dependable refrigeration controls to insure the proper performance of your equipment and the preservation of your products.



- Control with electronic ease and precision
- Replace old mechanical thermostats
- Replace old defrost time clocks
- Preset alarm points
- Door open alarm



**MEDIUM TEMP CONTROLLER - DWC30 Off Cycle Defrost & Alarm** IDN 61660  
 XR30C Controller 16A Compressor (Valve) & 8A Alarm Relays  
 5 Ft. NTC Probe • C-Box Wall Mounting Enclosure

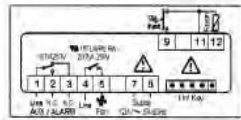

XR30

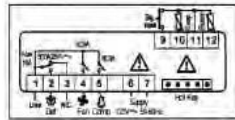

XR60

**LOW TEMP CONTROLLER - DWC60 Defrost & Fan** IDN 61670  
 XR60C Controller 16A Compressor (Valve) & 8A Defrost & 8A Fan Relays • (2) 5 Ft. NTC Probes  
 C-Box Wall Mounting Enclosure

# WALK-IN ALARM & LIGHT MANAGER

Introducing a total walk-in solution for Food Safety and Energy Savings...

The greatest detriments in the daily operation of walk-in coolers are doors left open and lights left on resulting not only in loss of energy but also in the compromising of food safety. Weiss Instruments/Dixell Controls is proud to offer the XWA11V compact and easy to use monitoring system.



## FEATURES:

- Hi / Low temperature alarms w/delays
- Lighting management - Auto off
- Door open alarm
- Panic alarm
- Battery back-up option
- Saves energy



IDN 61601

### XWA11V Kit includes:

- 5Ft. probe (can be extended to 300ft.)
- SST waterproof switch plate & Wall Mount Box
- Magnetic Door Switch
- 8A alarm relay
- 16A light relay
- Adjustable settings - optional programming HOT KEY
- 120VAC direct power - UL Listed

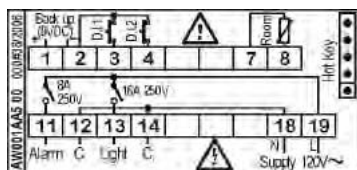

# DIGITAL THERMOMETER WITH SWITCH PLATE

Now you can combine your Light Switch and Digital Thermometer in one easy to install package. The waterproof "elbow" engaged illuminated light switch allows operators to turn on the walk-in light easily, even when their hands are full. The industrial duty light switch is rated at 15A, UL Listed and includes optional gasket for outdoor use.



- LED Temp Display with °F/°C switch
- 1 second, 1\*minute or 3 minute display update
- Light switch (15A) and SST J-Box Mount Cover
- 120V Direct Power
- Optional Battery back-up
- Save on installation costs







\*Standard 1 min. update

Cat. No.	Description	Power	°F/°C	Update	IDN
24DT	S=Switchplate	0=12Vac./DC 4=110Vac. 5=230Vac.	F=°F -40/230°F C=°C -40/110°C	0=1 sec. 1=1 min. 3=3 min.	60550
Ex: 24DT-S4F1	S      4	F      1			
	S - 110V - °F - 1 min.				
Cat. No.	Description	Power	°F/°C	Update	IDN
24DT	L=Switchplate w/ Lighted Switch	0=12Vac./DC 4=110Vac. 5=230Vac.	F=°F -40/230°F C=°C -40/110°C	0=1 sec. 1=1 min. 3=3 min.	60560
Ex: 24DT-L4F1	L      4	F      1			
	L - 110V - °F - 1 min.				

# REFRIGERATION / FREEZER CONTROLLERS

The Prime Series of Dixell controls by Weiss Instruments are the OEM choice for Electronic Controls for Refrigeration. Low cost and simple operation offers fully adjustable parameters for tight control and reliable operation. When looking for an OEM replacement, it is important to determine the exact part number on the label of the original unit. The following table shows all of the combinations. For probe replacements see Page 7. Note that all probes are thermistor, either PTC (which use white wire) or the newer NTC (which uses black wire). More advanced controls including those that can communicate to our Web Based Monitoring System, XWEB can also be found on our web site.

Please refer to our web page for detail documentation and instruction manuals.

<p>XR10C is a simple thermostat for heating or cooling. It includes visual alarms</p>	 <p><b>XR10C</b></p>	<p>120V Power 1x 16A (96LRA) relay 1 NTC (PTC) Probe</p>
<p>XR20C is a medium temp control with Off-cycle defrost. It includes visual alarms</p>	 <p><b>XR20C</b></p>	<p>120V Power 1x 16A (96LRA) relay</p>
<p>XR30C is a medium temp control with Off-cycle defrost. It includes visual alarms and alarm relays</p>	 <p><b>XR30C</b></p>	<p>120V Power 1x 16A (96LRA) relay 8A alarm relay 1 NTC (PTC) Probe</p>
<p>XR40C is a medium / low temp control with interval defrost. It includes visual alarms and output for electric or hot gas defrost.</p>	 <p><b>XR40C</b></p>	<p>120V Power 1x 16A (96LRA) relay 1 x 8A Defrost / fan</p>
<p>XR60C is a low temp control with interval defrost and fan control. It includes visual alarms and output for electric or hot gas defrost. Separate fan relay allows for fan delay with defrost.</p>	 <p><b>XR60C</b></p>	<p>120V Power 1x 16A (96LRA) relay 1 x 8A Defrost 1 x 8A Fan 2 NTC (PTC Probes)</p>

## HOW TO ORDER

X R x x C - A B C D E      xx = 10,20,30,40,60

A	B	C	D	E
<b>Power Supply</b> 0= 12V 1= 24V 4= 120V 5= 230V	<b>Probe Type</b> P = PTC (white wire) N = NTC (black wire)	<b>Buzzer</b> 1 = No Buzzer (std) 0 = w/ Buzzer (opt.)	<b>Unit</b> C = °C F = °F	<b>Compressor Relay</b> 0= 8A 1 = 16FLA/96LRA 3 = 16FLA/60LRA* *XR60C only

Ex.: XR40C-4N1F1 = 120V – NTC – No Buzzer – °F – 16/96A relay

Cat. No.	Description	Range	Power Relay	IDN
XR10C-4N1F1	Heat/Cool	-50/230F	120V / 16FLA/96LRA	61600
XR20C-4N1F1	Med/Temp Off-Cycle Defrost	-50/230F	120V / 16FLA/96LRA	61610
XR30C-4N3F1	Med/Temp Off-Cycle Defrost	-50/230F	120V / 16FLA/96LRA	61612
XR40C-4N1F1	Low-Med/Temp Time/Temp Defrost	-50/230F	120V / 16/60	61615
XR60C-4N1F3	Low Temp - Defrost, Comp, Fan	-50/230F	120V / 16/60	61620
18NB-NTC-1.5M	Sensor Probe 1/4" x 1.8" x 5ft. length	-50/230F		61640



# DIXELL PROBES & ACCESSORIES

	CATALOG NO.	DESCRIPTION	RANGE	IDN
	18NB-PTC-05FT	PTC 1.8" Nickel Plated Brass Thermistor - White Wire	-58/302F	70103
	18NB-NTC-1.5M	NTC 1.8" Nickel Plated Brass Thermistor - Black Wire	-50/230F	70168
	30SS-PTC-05FT	PTC 3" Stainless Steel Thermistor - White Wire	-58/302F	70109
	30SS-NTC-1.5M	NTC 3" Stainless Steel Thermistor - Black Wire	-50/230F	70111
	Hot Key	For Quick Downloading of Program Settings		70200
	019-0001 019-0002	1/4" NPT Compression Fitting 1/2" NPT Compression Fitting For use on 30SS Probes		70211 70215
	315-0015-01	Gasket (weather proof)		70220
	C-Box	For use with all XR Controllers Cut out 29mm x 71mm - Wall Mounting		70230
	A2700	Outboard Relay 30A - 120V Coil 1.5HP (SPST)		70240



# DIGITAL DIFFERENTIAL THERMOMETERS



DT52A-4

## SERIES DTA HAND HELD

Cat. No.	Range	Probe	IDN
DT51A-1	-50/1999°F	KG	61220
DT52A-2	-50/1999°F	2-KS	61230
DT52A-4	-50/1999°F	2-KS,KG,KB	61240

## PROBES

Cat. No	Description	Length	IDN
KS	Type K Surface probe w/velcro	8ft.	61250
KA	Type K Air/Surface probe	8ft.	61260
KG	Type K General Purpose probe	8ft.	61270
KP	Type K Puncture Probe	5ft.	61280
KO	Type K Oven probe	8ft.	61290
KL	Type K Long Velcro	8ft.	61255
KB	Type K Bead probe	8ft.	61265

FEATURES	DT51A-1	DT52A-2	DT52A-4
Number of Probes	1-KG	2-KS	2-KS,1KG,1KB
Differential Measurement	no	yes	yes
°F or °C switch	yes	yes	yes
Resolution 0.1° / 1°	yes	yes	yes
Data Hold - Max Hold	yes	yes	yes
Battery included	yes	yes	yes
Carrying Case	yes	yes	yes
Pouch Case	-	-	-

The Serviceman today needs an instrument that is reliable, durable and accurate, has usable functions and probes for measuring refrigeration and air-conditioning systems, and is reasonably priced. The Weiss DT51A and DT52A offer such a product for temperature measurement.

The DT51A-1 is a type K thermocouple based single probe thermometer with a range of -50/1999°F, resolution switch (0.1°F or 1°F), Data Hold feature, Max Memory, °F or °C switch and includes a general use probe.

The DT52A-4 is also type K thermocouple with two probe inputs that offer the differential feature required in refrigeration and air-conditioning service. Includes two velcro probes with the sensor built in, plus a bead probe and general probe with handle in an ABS carrying case.

# DIGITAL DIFFERENTIAL PROBES

## SPECIFICATIONS

### ELECTRICAL

Measurement Range: -50 to 1300°C -50 to 1999°F  
Resolution: 0.1° or 1°

### ENVIRONMENTAL

Ambient Operating Range: 0 to 50°C 32 to 122°F  
Storage Temperature: -10 to 60°C -14 to 140°F  
Humidity: 0% to 90% (0 to 35°C) 0% to 70% (35 to 50°C)

### ACCURACY

For single-thermocouple measurements.  
For T1-T2 Measurements accuracy is:  
±(0.3% of T1-T2 reading +2°C)  
±(0.3% of T1-T2 reading +3°F)

### GENERAL

**Weight:** 206 GM (7.2 oz)  
**Dimension:** 5.31"L x 2.83"W x 1.22"H (135x72x31mm)  
**Battery:** Standard 9V battery (NEDA 1604,6F22,or 006P)  
**Battery life:** Approx.150 hours.  
**Display:** (4) 1/2" digit liquid crystal display, 14mm high LCD.  
**Yellow Grip Sleeve:** Included.  
**Data Hold Feature - Max Hold Feature**  
**Output Jack:** For temperature recording or computer interface.  
**Instruction manual:** Included.

Cat No.	Description	Range	IDN
KS KL	Surface Probe w/ Velcro Long Velcro (31")	-50-200F (-50-95C)	61250 61255
KA	Air/Surface Probe	-50-260F (-50-125C)	61260
KG	General Purpose Probe	-50-350F (-50-175C)	61270
KP	Puncture Probe	0-400F (0-205C)	61280
KO	Oven Probe	0-1300F (0-705C)	61290
KB	Bead Probe	-50-350F (-50-175C)	61265



# DIGITAL THERMO - ANEMOMETER



CFM-01

The CFM-01 is a valuable tool in the measurement of Air Flow and Air Temperature and will automatically calculate CFM's & CMM (cubic ft. per minute and cubic meters per minute). Instant/Average and 2/3V max Flow Measurements are simply and easily obtained using the 12 key pads to enter the duct or hood area in feet or meters and displayed on the LCD Dual Readout. Air velocity can be measured in m/s, ft/min, knots, km/hr. and mph. Temperature readings are obtained with a fast response type K thermocouple.

- CFM made easy •Large LCD Dual Display •°F/°C
- Auto Off •9V Battery and Carrying Case included

Cat No.	Description	IDN
CFM-01	Thermo-Anemometer	61405

## SPECIFICATIONS

**Display:** 1/2" & 3/8" digits.

**Bearing:** Sapphire jewel bearing.

**Operating Temperature:** Meter 32°F–122°F (0°C–50°C)  
Vane 32°F–140°F (0°C–60°C)

**Operating Humidity:** Less than 80% RH

RANGE OF WIND TEMPERATURE				RANGE OF WIND VELOCITY			
Units	Range	Resolution	Accuracy	Units	Range	Resolution	Accuracy
°C	0.0–45.0	0.2	±1.0°C	m/s	0.0–45.0	0.1	±3%±0.1
°F	32.0–113.0	0.36	±1.8°F	ft/min	0.0–8800	0.1/1	±3%±10
				knots	0.0–88.0	0.1	±3%±0.1
				Km/hr	0.0–140.0	0.1	±3%±0.1
				mph	0.0–100.0	0.1	±3%±0.1

# LCD REMOTE READING DIGITAL THERMOMETERS



56SD-160

72SD-F

25SD-160

20SD-FS

20SD-HL

Weiss Instruments is the leader in Solar Powered technology\* as we now offer seven different versions of our Digital thermometers. Available in low light version 56SD, (15 Lux) 25SD, 72SD, (30 Lux) and Series 20SD (75 Lux). These "self powered" thermometers operate without any batteries and offer an attractive and modern update to existing refrigeration equipment. Each thermometer has adjustable calibration, a ten second update time and wide ambient temperature specifications for both indoor and outdoor installations.

\*Patent No. 5,196,781

Series SD - LCD						
NSF Model	Cat. No.	Case	Range <sup>1</sup>	Sensor Length <sup>3</sup>	IDN	
SD	20SD-BS	Back Flange	40/0/160°F	05ft	60110	
SD	20SD-HL	Hanging	40/0/160°F	05ft	60160	
SD	20SD-FS	Front Flange	40/0/160°F	05ft	60100	
SD	25SD-160	Horiz. Wall Mount <sup>4</sup>	40/0/160°F	05ft	60170	
SD	56SD-160	Front Flange	50/0/160°F <sup>2</sup>	05ft	60120	
SD	72SD-F-160	Front Flange	40/0/160°F	05ft	60140	
SD	72SD-U-160	U-Clamp	40/0/160°F	05ft	60150	
Economy Battery Type Panel Meter						IDN
LC58	Panel Mount with clips		40/0/230°F	04ft	60205	



LC58

1. Equivalent °C available, consult Factory. 2. Features °F/°C switch. 3. Longer line lengths available. 4. Offered in black or white case

# NSF REMOTE READING DIAL THERMOMETERS



The Weiss Line of Remote Reading Dial Thermometers offers a wide variety of dial sizes and case configurations to match any installation. All items are furnished in attractive stainless steel cases and all models are NSF listed. Additional features include smart color zoned dual scales and tin plated thermal systems.

## 2" DIAL SIZE

SERIES FB - FRONT FLANGE BACK CONNECT					SERIES HL - HANGING BRACKET LOWER CONNECT				
NSF MOD.	CAT. NO.	RANGE	CAPILLARY	IDN	NSF MOD.	CAT. NO.	RANGE	CAPILLARY	IDN
RF	20FB-060	40-0-60 F&C	48"	40110	RH	20HL-060	40-0-60 F&C	48"	40170
RF	20FB-960	40-0-60 F&C	9"	40115	HF	20HL-240	40-240 F&C	48"	40180
RF	20FB-260	40-0-60 F&C	20 FT	40120					
RF	20FB-110	40-0-110 F&C	48"	40130	SERIES FL - FRONT FLANGE LOWER CONNECT				
HF	20FB-240	40-240 F&C	48"	40140	NSF MOD.	CAT. NO.	RANGE	CAPILLARY	IDN
					HF	20FL-240	40-240 F&C	48"	40160
SERIES BB - BACK FLANGE BACK CONNECT					SERIES UB - U CLAMP BACK CONNECT				
NSF MOD.	CAT. NO.	RANGE	CAPILLARY	IDN	NSF MOD.	CAT. NO.	RANGE	CAPILLARY	IDN
RF	20BB-060	40-0-60 F&C	48"	40220	RU	20UB-060	40-0-60 F&C	48"	40190
RF	20BB-110	40-0-110 F&C	48"	40230	HU	20UB-220	100-220 F&C	48"	40210
HF	20BB-240	40-240 F&C	48"	40240	HU	20UB-240	40-240 F&C	48"	40200

## 2 1/2" DIAL SIZE

SERIES FB - FRONT FLANGE BACK CONNECT					SERIES HL - HANGING BRACKET LOWER CONNECT				
NSF MOD.	CAT. NO.	RANGE	CAPILLARY	IDN	NSF MOD.	CAT. NO.	RANGE	CAPILLARY	IDN
RF	25FB-060	40-0-60 F&C	48"	40250	RH	25HL-060	40-0-60 F&C	48"	40280
RF	25FB-110	40-0-110 F&C	48"	40260					
HF	25FB-240	40-240 F&C	48"	40270	SERIES PB - PLAIN W/LOCK NUT BACK CONNECT				
SERIES BB - BACK FLANGE BACK CONNECT					NSF MOD.	CAT. NO.	RANGE	CAPILLARY	IDN
RF	25BB-110	40-0-110 F&C	48"	40295	RU	25PB-060	40-0-60 F&C	48"	40290

# NSF REMOTE READING DIAL THERMOMETERS

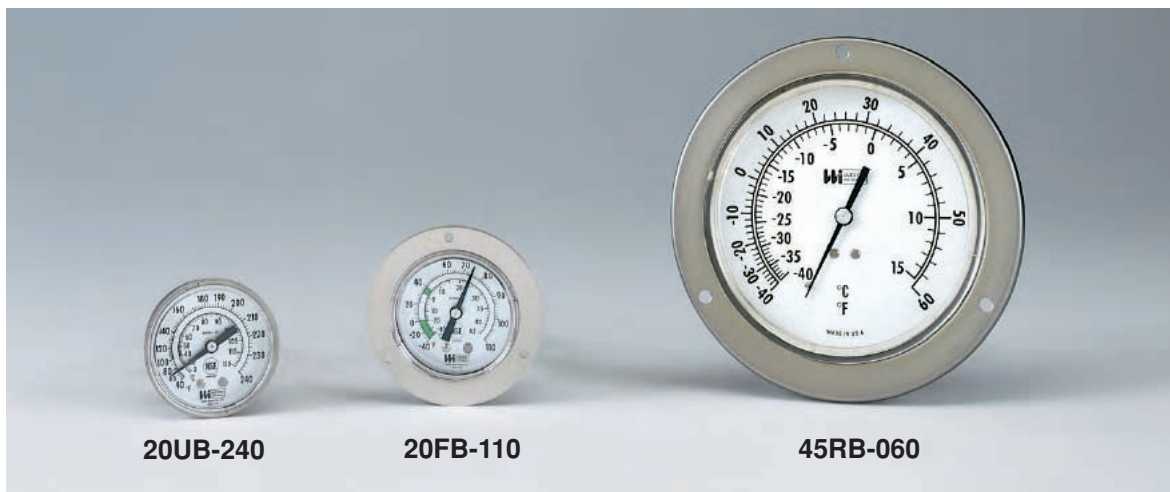

20UB-240

20FB-110

45RB-060

## 4 1/2" DIAL SIZE

SERIES RB - FRONT FLANGE BACK CONNECT					SERIES BB - BACK FLANGE BACK CONNECT				
NSF MOD.	CAT. NO.	RANGE	CAPILLARY	IDN	NSF MOD.	CAT. NO.	RANGE	CAPILLARY	IDN
RF	45RB-060	40-0-60 F&C	48"	40310	RF	45BB-060	40-0-60 F&C	48"	40350
RF	45RB-260	40-0-60 F&C	20 FT	40320	RF	45BB-260	40-0-60 F&C	20 FT	40360
RF	45RB-110	40-0-110 F&C	48"	40330	RF	45BB-110	40-0-110 F&C	48"	40370
HF	45RB-240	40-240 F&C	48"	40340	HF	45BB-240	40-240 F&C	48"	40380

# UNION CONNECTED DIAL THERMOMETERS



45BL-100

Offered in 3 1/2" and 4 1/2" dial sizes the Series BL is furnished with braided copper capillary and a 1/2" NPT brass union connection. Sensor bulb insertion is 2 5/8" below the mounting thread. Case configuration is stainless steel back flange type for wall or surface mounting, capillary outlet at case bottom.\* The Series BL construction is well suited to applications such as hot and chilled pipeline systems, tanks, coolers and air ducts.

DIAL SIZE	CAT. NO.	RANGE	CAPILLARY	IDN
3 1/2"	35BL-060	40-0-60 F&C	5 FT	42070
3 1/2"	35BL-110	40-0-110 F&C	5 FT	42080
3 1/2"	35BL-100	20-0-100 F&C	5 FT	42090
3 1/2"	35BL-180	0-180 F&C	5 FT	42100
3 1/2"	35BL-240	40-240 F&C	5 FT	42110
4 1/2"	45BL-060	40-0-60 F&C	5 FT	42010
4 1/2"	45BL-110	40-0-110 F&C	5 FT	42020
4 1/2"	45BL-100	20-0-100 F&C	5 FT	42030
4 1/2"	45BL-180	0-180 F&C	5 FT	42040
4 1/2"	45BL-240	40-240 F&C	5 FT	42050

\* Also available with back outlet, specify 35BB or 45BB.

# DIGITAL VARI-ANGLE THERMOMETERS



SPECIFICATIONS		
<b>CASE</b>	Hi-impact ABS	
<b>RANGE</b> with F/C Switch	-50/ 300 °F -45/150 °C	
<b>DISPLAY</b>	1/2" LCD digits, wide ambient formula	
<b>ACCURACY</b>	1% of reading or 1° whichever is greater	
<b>RESOLUTION</b>	1/10° between -19.9/199.9 °F (-28/93 °C)	
<b>RECALIBRATION</b>	Internal potentiometer	
<b>LUX RATING</b>	10 Lux (one foot-candle)	
<b>UPDATE</b>	10 seconds	
<b>AMBIENT OPERATING</b>	-30/140 °F (-35/60 °C)	
<b>AMBIENT TEMP ERROR</b>	Zero	
<b>HUMIDITY</b>	100%	
<b>SENSOR</b>	Glass passivated thermistor - NTC	
<b>STEM ASSEMBLIES</b>	<b>INDUSTRIAL GLASS</b>	<b>BIMETALLIC</b>
	Full conformance with Fed Spec GG-T-321D.	Full conformance with ASME B40.3 - 1990.
	Fully interchangeable with Industrial Glass Thermometers.	Fully interchangeable with Bimetallic Dial Thermometers.

The Weiss patented,\* Digital Vari-angle® Thermometer maintains the strict requirements for thermometers in hydronic applications in that they're self-powered and within 1% accuracy. This reliable series of digital thermometers offers the added feature of stem assemblies for direct replacement of mercury-in-glass types where environmental concerns exist. Whether on new installations or replacements, our Vari-angle Digital Thermometers include the same level of quality that the industry associates with the Vari-angle trademark and all Weiss Products.

\*Patent No. 5,196,781      ©Vari-angle is a registered trademark of Weiss Instruments, Inc.



CAT. NO.	DESCRIPTION	IDN
DVU35	3 1/2" Industrial Stem	62100
DVU6	6" Industrial Stem	62110
E35-75BS*	3/4" NPT 3 1/2" Socket	20300
ER6-75BS*	3/4" NPT 6" Socket	20500
EN6-75BS*	3/4" NPT 6" Ext. Socket	20501
DVBM25	2 1/2" x 1/2" NPT Stem	62120
DVBM4	4" x 1/2" NPT Stem	62130
DVBM6	6" x 1/2" NPT Stem	62140
DVD6	6" Stem w/ Duct Mtg. Flange	62310
DVD9	9" Stem w/ Duct Mtg. Flange	62320

\*For use with DVU thermometers on new installations.

Cat No.	Description	IDN
DVC-4	Outdoor Waterproof Cover (4 pcs per pack)	62410





# INDUSTRIAL GLASS THERMOMETERS



Weiss 9" Scale Vari-angle Thermometers are the industry standard for HVAC applications. Union connection stem is offered for pipe-line applications, for chilled and hot water installations with a 3 1/2" stem. Perforated 6" stem with a mounting flange is for air duct use. Blue Liquid is standard.

UNION CONN. STEM			SOCKETS		
CAT. NO.	RANGE	IDN	CAT. NO.	DESCRIPTION	IDN
9VU35-110	40-0-110F&C	20315	E35-75BS*	3/4"NPT 3 1/2" Socket	20300
9VU35-120	0-120F&C	20325	ER6-75BS*	3/4"NPT 6" Socket	20500
9VU35-160	0-160F&C	20335	EN6-75BS*	3/4"NPT 6" Ext.Socket	20501
9VU35-180	30-180F&C	20345	<b>AIR DUCT STEM</b>		
9VU35-240	30-240F&C	20355	<b>CAT. NO.</b>	<b>RANGE</b>	<b>IDN</b>
9VU35-300	30-300F&C	20365	9VD6-120	0-120F&C	20420
9VU6-110	40-0-110F&C	20510	9VD6-160	0-160F&C	20430
9VU6-120	0-120F&C	20520	9VD6-180	0-180F&C	20440
9VU6-160	0-160F&C	20530	*For use with 9VU thermometers on new installations.		
9VU6-180	30-180F&C	20540			
9VU6-240	30-240F&C	20550			

# TRADE LINE THERMOMETERS



Weiss TL Thermometers are intended for small pipeline applications for chilled and hot water installations. The compact design is also suitable to limited space requirements. Units are furnished with 5" scale and 2" stem including a 1/2" NPT separable socket.

STRAIGHT FORM TYPE			ANGLE FORM TYPE		
CAT. NO.	RANGE	IDN	CAT. NO.	RANGE	IDN
TL5S2-110	-40-0-110F&C	20213	TL5A2-110	-40-0-110F&C	20215
TL5S2-120	20-120F&C	20203	TL5A2-120	20-120F&C	20205
TL5S2-180	20-180F&C	20223	TL5A2-180	20-180F&C	20225
TL5S2-240	30-240F&C	20204	TL5A2-240	30-240F&C	20206
TL5S2-300	30-300F&C	20214	TL5A2-300	30-300F&C	20226

# REFRIGERATION GAUGES



These gauges are designed for the pressure measurement of refrigeration systems. Most dials are furnished with corresponding temperature scales for the various refrigerants shown below. Standard connections are 1/8" NPT bottom for manifold gauges and 1/4" NPT for all other versions.

TYPE	CAT. NO.	RANGE	REFRIG.SCALE	CASE	ACCURACY	IDN
Dry 2 1/2" Dial Manifold	RG25-120 RG25-500	30-0-120 PSI 0-500 PSI	R12, R22, R502 R12, R22, R502	STAINLESS STEEL RED/BLUE	ANSI GRADE B 2% MID SCALE	83010 83020
Liquid Filled 2 1/2" Dial Manifold	LFM502H LFM502L  LFM507H LFM507L	0-500PSI 30-0-120PSI  0-500PSI 30-0-120PSI	R12, R22, R502 R12, R22, R502  R134a,404A, 507 R134a,404A, 507	STAINLESS STEEL RED/BLUE  STAINLESS STEEL RED/BLUE	ANSI GRADE B 2% MID SCALE  ANSI GRADE B 2% MID SCALE	83020 83010  83031 83032
Liquid Filled 2 1/2" Dial Panel Mount	LFM410H LFM410L LFM502H-F LFM502L-F LFM502H-U LFM502L-U	0-800PSI 30-0-250PSI 0-500PSI 30-0-120PSI 0-500PSI 30-0-120PSI	R410A R410A R12, R22, R502 R12, R22, R502 R12, R22, R502 R12, R22, R502	STAINLESS STEEL RED/BLUE STAINLESS STEEL FRONT FLANGE U-CLAMP	ANSI GRADE B 2% MID SCALE ANSI GRADE B 2% MID SCALE	83033 83034 83027 83026 83029 83028
2 1/2" Dial Liquid Filled Stem Mount	LF251-030-4L LF251-060-4L LF251-100-4L LF251-160-4L LF251-200-4L LF251-300-4L LF251-600-4L	0-30 PSI 0-60 PSI 0-100 PSI 0-160 PSI 0-200 PSI 0-300 PSI 0-600 PSI		STAINLESS STEEL	ANSI GRADE B 2% MID SCALE	83051 83052 83053 83054 83055 83056 83057
2 1/2" Dial Liquid Filled Front Flange	LF251F-300-4B LF251F-600-4B LF251F-V150-4B LF251F-V300-4B	0-300 PSI 0-600 PSI 30-0-150 PSI 30-0-300 PSI		STAINLESS STEEL	ANSI GRADE B 2% MID SCALE	84120 84160 84210 84220
3 1/2" Dial Back Flange	RG35-V150 RG35-V300 RG35-0300 RG35-0500	30-0-150 PSI 30-0-300 PSI 0-300 PSI 0-500 PSI	R12, R22, R502 R12, R22, R502 R12, R22, R502 R12, R22, R502	STAINLESS STEEL	ANSI GRADE A 1% MID SCALE	83030 83040 83050 83060
4 1/2" Dial Turret	4RG-150 4RG-300	30-0-150 PSI 30-0-300 PSI	R12, R22, R502 R12, R22, R502	PHENOLIC	ANSI GRADE 1A 1% FULL SCALE	83070 83080

## TEMP / PRESSURE TEST PLUGS

Weiss Temperature/Pressure Plugs allows for quick, efficient and accurate testing of hydronic pipe lines throughout HVAC systems. Offered in both nardel (blue cap) for hot and chilled water and neoprene (red cap) for natural gas. Weiss plugs are consistently rated at 1000 psi. The self-sealing core insures long life and continuous service.

CAT. NO.	DESCRIPTION	BODY & CAP	IDN	CAT. NO.	ACCESSORIES	IDN
BP25-NR	1/4" NPT Nordel	Brass	90101	TPK	Test Kit	90120
BP25-NP	1/4" NPT Neoprene	Brass	90102	GA18	Gauge Adapter	90125
BP50-NR	1/2" NPT Nordel	Brass	90103	PT220	1" Dial Pocket Test 0/220°F	90130
BP50-NP	1/2" NPT Neoprene	Brass	90104	PT125	1" Dial Pocket Test 0/125°F	90110
BP25L-NR	1/4" NPT Nordel w/ 1 3/4" Lag	Brass	90105	TL25-030-4L	2 1/2" Gauge 0-30 psi	90131
BP25L-NP	1/4" NPT Neoprene w/ 1 3/4" Lag	Brass	90106	TL25-160-4L	2 1/2" Gauge 0-160 psi	90134

BP25-NR

BP25L-NR  
BP50-NR

# AMMONIA GAUGES

• Heavy Duty Internals on 4 1/2" Gauges

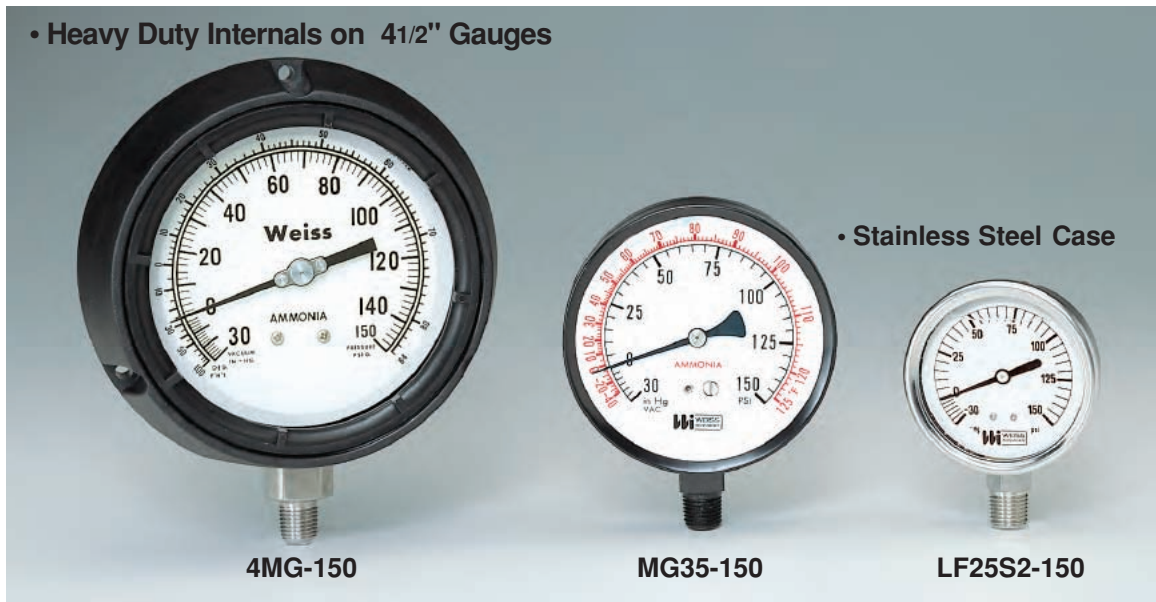

• Stainless Steel Case

These gauges are designed for the pressure measurement of any system or equipment charged with ammonia. Most dials are furnished with corresponding temperature scales. Black inner arc indicates pressure. Red outer arc indicates corresponding temperature. All gauges are equipped with restrictors to protect the gauges against pulsating pressure.

TYPE	CAT. NO.	RANGE	CASE	TUBE & SOCKET	ACCURACY	IDN
2 1/2" Dial Liquid Filled	LF25S2-150	30-0-150 PSI	STAINLESS STEEL	316 S.S.	ANSI GRADE B 2% MID SCALE	84610
	LF25S2-300	30-0-300 PSI				84620
2 1/2" Dial 3 1/2" Dial	MG25-150	30-0-150 PSI	BLACK STEEL	316 S.S. TUBE STEEL SOCKET	ANSI GRADE B 2% MID SCALE	83110
	MG25-300	30-0-300 PSI				83115
	MG35-150	30-0-150 PSI				83120
	MG35-300	30-0-300 PSI				83130
4 1/2" Dial	4MG-150	30-0-150 PSI	PHENOLIC	316 S.S.	ANSI GRADE A 1% MID SCALE	83140
	4MG-300	30-0-300 PSI				83150

# DIAPHRAGM GAUGES



The Weiss Series DG Gauges are used in the measurement of pressures below 10 psi. This line of diaphragm gauges offers an instrument highly sensitive yet durably constructed. Utilizing a thin walled copper-alloy, the diaphragm senses slight pressure or vacuum and expands or contracts. The action of the element is quickly and accurately indicated within 1.5% of full scale range. Some of the uses are filter monitoring, leak testers and LP gas.

**CASE** - Black drawn steel, with twist lock polycarbonate window. **DIAPHRAGM** - Copper alloy. **SOCKET** - Brass, 1/4" NPT lower or center back connection. **MOVEMENT** - Brass. **DIAL** - White coated metal lithographed with black graduations lines and numerals. **POINTER** - Balanced design, aluminum in black finish.

TO SPECIFY						
SERIES	SIZE	RANGE TYPE	CASE STYLE	NPT	MOUNT	RANGE
DG	2 1/2" 25	P3-Pressure V3-Vacuum C3-Combination	U-U Clamp	1/4"	LM* CBM**	—

Ex: DG25P3 1/4" LM 0-10psi \*LM - Lower Mount \*\*CBM - Center Back Mount

PRESSURE RANGE	COMBINATION	
	IN. WATER OUTER SCALE	OZ. WATER INNER SCALE
0-3 psi*	0-35	0-20
0-5 psi		
0-10 psi		
<b>inch/water</b>	0-15	0-9
0-15	0-60	0-35
0-30		
0-60		
0-100		
<b>oz.-sq. in.</b>	<b>VACUUM - in water vac.</b>	
	<b>RANGE</b>	
0-10	30-0	
0-15*	60-0	
0-30	100-0	
0-100		

\* Lower Connection only



# HVAC GAUGES

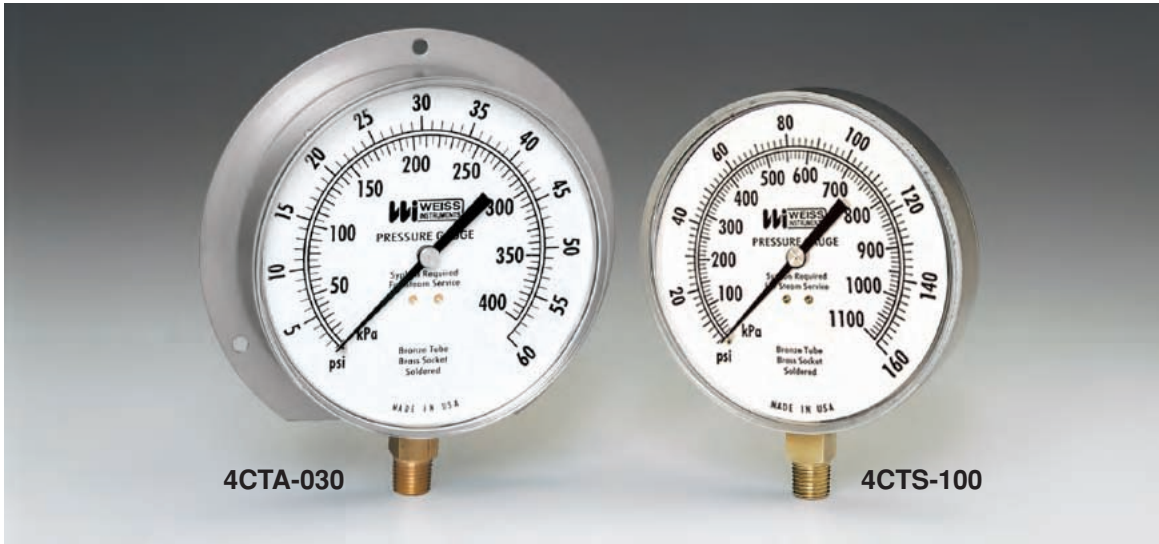

Weiss CTS/CTA Pressure Gauges are designed to meet the standard specifications for Heating, Cooling and Air Conditioning applications. Two types are offered for either stem or surface mounting. Both versions conform with ANSI B40.1 accuracy Grade 1A% full scale.

STAINLESS STEEL CASE STEM MOUNTED			STAINLESS STEEL CASE-BACK FLANGE SURFACE MOUNTED		
CAT. NO.	RANGE	IDN	CAT. NO.	RANGE	IDN
4CTS-015	0-15 PSI	82010	4CTA-015	0-15 PSI	82110
4CTS-030	0-30 PSI	82020	4CTA-030	0-30 PSI	82120
4CTS-060	0-60 PSI	82030	4CTA-060	0-60 PSI	82130
4CTS-100	0-100 PSI	82040	4CTA-100	0-100 PSI	82140
4CTS-160	0-160 PSI	82050	4CTA-160	0-160 PSI	82150
4CTS-200	0-200 PSI	82060	4CTA-200	0-200 PSI	82160
4CTS-300	0-300 PSI	82070	4CTA-300	0-300 PSI	82170
4CTS-VAC	0-30" HG VAC	82080	4CTA-VAC	0-30" HG VAC	82180
4CTS-V30	30-0-30 PSI	82090	4CTA-V30	30-0-30 PSI	82190
4CTS-V60	30-0-60 PSI	82100	4CTA-V60	30-0-60 PSI	82200

# TRI-O-METERS

The Weiss Tri-o-meter is designed for use on all types of hot water heating systems. One instrument reads the water pressure, water temperature and system head in feet of H<sub>2</sub>O. Available in 2 1/2" dial with 1/4" NPT rear connection and 3 1/2" dial with 1/2" NPT lower or rear connected.

<b>Series C</b>	0-75 psi & Ft. of H <sub>2</sub> O	60-260F&C
<b>H</b>	0-200 psi & kPa	80-320F&C
<b>CAT. NO.</b>	<b>DESCRIPTION</b>	<b>IDN</b>
CTP25R	1/4" NPT Rear	28807
CTP25RX	1/4" NPT Rear x 2" Ext.	28808
CTP40RSX	1/2" NPT Rear	28810
CTP40L	1/2" NPT Lower	28811
HTP40RSX	1/2" NPT Rear	28812
HTP40L	1/2" NPT Lower	28813

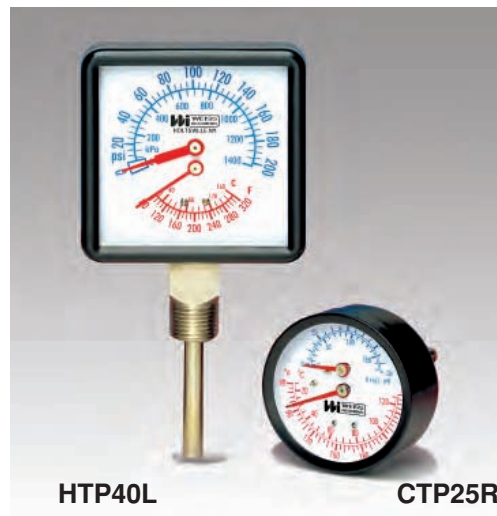



# TRADE LINE GAUGES



Weiss TL Gauges are intended for general service conditions, for pressure or vacuum on air, oil, water, gas or other mediums that do not attack brass. TL Gauges are furnished in drawn steel cases, finished in black. The 1 1/2" dials are supplied with 1/8" NPT and 2" dial versions are available with 1/4" or 1/8" NPT connections. All other dial sizes are 1/4" NPT. All gauges conform with ANSIB40.1 accuracy Grade B-2% mid scale.

1 1/2" DIAL 1/8" NPT LOWER CONN.			1 1/2" DIAL 1/8" NPT BACK CONN.		
CAT. NO.	RANGE	IDN	CAT. NO.	RANGE	IDN
TL15-030-8L	0-30 PSI	80010	TL15-030-8B	0-30 PSI	80035
TL15-060-8L	0-60 PSI	80015	TL15-060-8B	0-60 PSI	80040
TL15-100-8L	0-100 PSI	80020	TL15-100-8B	0-100 PSI	80045
TL15-160-8L	0-160 PSI	80025	TL15-160-8B	0-160 PSI	80050
TL15-200-8L	0-200 PSI	80030	TL15-200-8B	0-200 PSI	80055
2" DIAL 1/4" NPT LOWER CONN.			2" DIAL 1/8" NPT LOWER CONN.		
CAT. NO.	RANGE	IDN	CAT. NO.	RANGE	IDN
TL20-015-4L	0-15 PSI	80101	TL28-030-8L	0-30 PSI	80116
TL20-030-4L	0-30 PSI	80102	TL28-060-8L	0-60 PSI	80117
TL20-060-4L	0-60 PSI	80103	TL28-100-8L	0-100 PSI	80118
TL20-100-4L	0-100 PSI	80104	TL28-160-8L	0-160 PSI	80119
TL20-160-4L	0-160 PSI	80105	TL28-200-8L	0-200 PSI	80120
TL20-200-4L	0-200 PSI	80106	TL28-300-8L	0-300 PSI	80121
TL20-300-4L	0-300 PSI	80107	TL28-VAC-8L	0-30" HG VAC	80122
TL20-VAC-4L	0-30" HG VAC	80108	TL28-V150-8L	30-0-150 PSI	80112
TL20-V30-4L	30-0-30 PSI	80109			
TL20-V100-4L	30-0-100 PSI	80111			
2 1/2" DIAL 1/4" NPT LOWER CONN.			3 1/2" DIAL 1/4" NPT LOWER CONN.		
CAT. NO.	RANGE	IDN	CAT. NO.	RANGE	IDN
TL25-015-4L	0-15 PSI	80130	TL35-015-4L	0-15 PSI	80145
TL25-030-4L	0-30 PSI	80131	TL35-030-4L	0-30 PSI	80146
TL25-060-4L	0-60 PSI	80132	TL35-060-4L	0-60 PSI	80147
TL25-100-4L	0-100 PSI	80133	TL35-100-4L	0-100 PSI	80148
TL25-160-4L	0-160 PSI	80134	TL35-160-4L	0-160 PSI	80149
TL25-200-4L	0-200 PSI	80135	TL35-200-4L	0-200 PSI	80150
TL25-300-4L	0-300 PSI	80136	TL35-300-4L	0-300 PSI	80151
TL25-VAC-4L	0-30" HG VAC	80137	TL35-VAC-4L	0-30" HG VAC	80152
TL25-V30-4L	30-0-30 PSI	80138	TL35-V30-4L	30-0-30 PSI	80153
TL25-V60-4L	30-0-60 PSI	80139	TL35-V60-4L	30-0-60 PSI	80154
TL25-V100-4L	30-0-100 PSI	80140	TL35-V100-4L	30-0-100 PSI	80155
TL25-V150-4L	30-0-150 PSI	80141	TL35-V150-4L	30-0-150 PSI	80156
4 1/2" DIAL 1/4" NPT LOWER CONN.					
CAT. NO.	RANGE	IDN	CAT. NO.	RANGE	IDN
TL45-015-4L	0-15 PSI	80160	TL45-300-4L	0-300 PSI	80166
TL45-030-4L	0-30 PSI	80161	TL45-VAC-4L	0-30" HG VAC	80167
TL45-060-4L	0-60 PSI	80162	TL45-V30-4L	30-0-30 PSI	80168
TL45-100-4L	0-100 PSI	80163	TL45-V60-4L	30-0-60 PSI	80169
TL45-160-4L	0-160 PSI	80164	TL45-V100-4L	30-0-100 PSI	80170
TL45-200-4L	0-200 PSI	80165	TL45-V150-4L	30-0-150 PSI	80171

# GENERAL PURPOSE THERMOMETERS



The instruments illustrated here are general purpose type. The group consists of bimetal dial, glass pocket clip, wall mounting, vertical and hanging bracket, indoor/outdoor and commercial 1/2" NPT bimetals for use in air ducts.

TYPE	CAT. NO.	RANGE	IDN
<b>DIAL THERMOMETERS</b>			
POCKET DIAL	PT125	25-125F	30110
POCKET DIAL	PT180	40-0-180F	30120
POCKET DIAL	PT220	0-220F	30130
1 3/4" DIAL	134-125	25-125F&C	30150
1 3/4" DIAL	134-160	40-0-160F&C	30160
1 3/4" DIAL	134-220	0-220F&C	30170
FLANGE STEM	25FBM7	40-0-60F	32492
FLANGE STEM	25FBM9	40-0-60F	32493
3" DIAL	3BM6-120	20-0-120F	33020
3" DIAL	3BM6-130	30-130F	33030
3" DIAL	3BM6-250	0-250F	33050
HANGING or STANDING	25HBM	20-0-80F&C	39130
<b>GLASS THERMOMETERS</b>			
POCKET GLASS	PLC120	30-0-120F	39010
POCKET GLASS	PLC220	0-220F	39030
VERTICAL HANGING	HB120	40-0-120F&C	39110
HORIZONTAL HANGING	HZ80	40-0-80F&C	39120
<b>DIGITAL THERMOMETERS</b>			
POCKET DIGITAL/AUTO OFF	DP300	58-0-302F&C	39140
POCKET DIGITAL/WATERPROOF	DP300A	58-0-302F&C	39145
<b>DRUM THERMOMETERS</b>			
REMOTE MOUNTING	DR58	40-0-60F&C	42391

# REFRIG / FREEZER THERMOMETERS

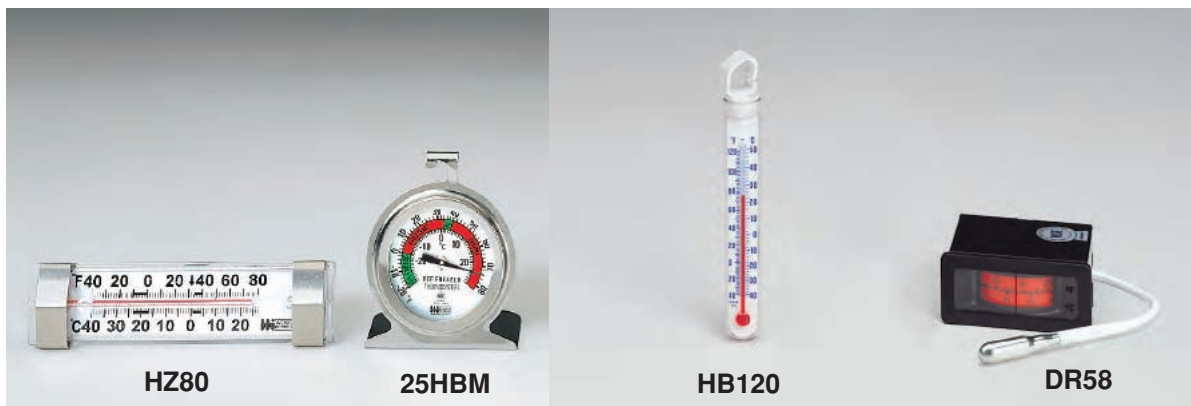

# DIGITAL TEMPERATURE HUMIDITY TESTER



RHT-1

## SPECIFICATIONS

### Electrical

**Display:** 3-1/2 Digit, 1/2" LCD Display

**Range:** Humidity: 10% - 95% RH  
Temperature: -20 - 140°F -30 - 60°C

**Resolution:** 0.1%RH, 0.1°F, 0.1°C

**Accuracy:** Humidity: 2% RH @ 25°C, 30- 95% RH  
5% RH @ 25°C, 10- 30% RH  
Temperature: ± 1.0°F, ±0.8°C

**Sensor Type:** Humidity: Precision Gold capacitance sensor  
Temperature: Semiconductor sensor

**Response Time:** Humidity: 45% - 95% < 3 minutes  
95% - 45% < 5 minutes  
Temperature: 1°C / 2 seconds

**Sampling Rate:** 2.5 times per second

**Auxiliary Outputs:** Humidity - 10mVdc / 1% RH  
Temperature - 10mVdc / 1°C

### Environmental

**Operating Temperature and Humidity:** 32 to 122°F\*  
0 to 50°C >85%RH

\*(-20 to 140°F will operate for limited time period)

**Storage Temperature and Humidity:** -10 to 60°C  
14 to 140°F >70%RH

### General

**Weight:** 200gm (7 oz.)

**Dimensions:** 10.6"L x 2.7"W x 1.0"H (270mm x 68mm x 25mm)

**Battery:** Standard 9V (NEDA 1604, 6F22 or 006P)

**Battery Life:** Approx. 400 hours

**Low Battery Indication:** "BT" indicates on the display.

### Series RHT-1

Cat. No.	Range	IDN
RHT	10% - 95% RH 4/0/140°F	61300

Accurate Humidity measurement at reasonable cost with usable functions is what best describes the Weiss Series RHT-1. This rugged hand held instrument features a wide humidity measurement range from 10% to 95% and a temperature range from -4°F to 140°F, (-20 to 60°C). Accuracy of 2% RH and 1°F, plus an °F/C switch, Hold feature and Output Jack make the RHT-1 ideal for HVAC and Refrigeration applications. The precision capacitance humidity sensor offers fast response and the output jack offers the ability to record data or remotely monitor both temperature and humidity. These features are normally found on instruments costing much more than the reasonably priced RHT-1, complete with 400 hour 9V battery and case.

# COMPACT THERMO/HYGROMETER

- Temperature, Humidity Indicator
- Desktop or Wall Mounted
- Compact Design

Series HT2096		
Cat. No.	Range	IDN
HT2096F	40/0/122°F	39170
HT2096C	40/0/70°C 15% - 95% RH	39175



HT2096

The Weiss Display can be wall bracket mounted or where space permits with floor stands. The versatile grid pattern allows for easy placement of packages for a neat and uniform display.



The packaging allows a full view of the package contents and is suitable for counter standing display.



**WEISS INSTRUMENTS, INC.**  
905 WAVERLY AVE., HOLTSVILLE, NY 11742  
TEL: (631) 207-1200 • FAX: 631.207.0900  
[www.weissinstruments.com](http://www.weissinstruments.com)

Distributed by



Old World Craftsmanship . . . NEW WORLD TECHNOLOGY  
Celebrating 125 Years



# WEISS INSTRUMENTS

Utility  
HVAC  
Diaphragm

## General Service Gauges



The Weiss Series TL Gauges are intended for general service conditions, for pressure or vacuum on air, oil, water, gas or other mediums that do not attack brass.

Steam Service Gauges should be protected from excessive temperature by the installation of a coil type syphon. (Cat.No. SY14-S iron or SY14-B brass)

**SPECIFICATIONS: TUBE & SOCKET** - Bronze, soft soldered to socket and tip. Brass socket.

**CASE & WINDOW** - Drawn steel case, finished in black with push-in polycarbonate window.

**DIAL** - White coated metal lithographed with black and red graduations lines and numerals, dual scale - psi & kPa.

**MOVEMENT** - All brass construction, precision gear and pinion, mounted on socket independent of case.

**POINTER** - Balanced design, aluminum in black finish.

**ACCURACY** 2% of the middle third of the entire range. ANSI-ASME B40.1 Grade B.

LOWER CONNECTION		
DIAL SIZE	CAT. NO.	NPT CONNECTION
1 1/2"	TL15	1/8"
2"	TL20	1/4"
2"	TL28	1/8" (Vacuum, 30psi thru 300psi)
2 1/2"	TL25	1/4"
3 1/2"	TL35	1/4"
4 1/2"	TL45	1/4"
CENTER BACK CONNECTION		
DIAL SIZE	CAT. NO.	NPT CONNECTION
1 1/2"	TL15	1/8"
2"	TL20	1/8" or 1/4"
2 1/2"	TL25	1/8" or 1/4"
3 1/2"	TL35	1/4"

TO SPECIFY				
CHOOSE CAT. NO. - PLUS RANGE CODE - PLUS CONNECTION				
INDICATES	RANGE	RANGE	SIZE &	LOCATION
DIAL SIZE	CODE			
TL15	1 1/2"	015	0-15	8L = 1/8" Lower
TL20	2"	030	0-30	8B = 1/8" Ctr Back
TL28	2"	060	0-60	4L = 1/4" Lower
TL25	2 1/2"	100	0-100	4B = 1/4" Ctr Back
TL35	3 1/2"	160	0-160	
TL45	4 1/2"	200	0-200	
		300	0-300	
		400	0-400	
		600	0-600	
		VAC	0-30"HG	
		V30	30-0-30	
		V60	30-0-60	
		V100	30-0-100	
		V150	30-0-150	
Ex: TL25 - 100 - 4L				

## HVAC Gauges - Series 4CTA



The Weiss HVAC Gauges meets the specifications of contractors in heating, plumbing, air conditioning and ventilating applications.

This Series of gauges are intended for general service conditions, for pressure or vacuum on air, oil, water, gas or other mediums that do not attack brass.

Steam Service Gauges should be protected from excessive temperature by the installation of a coil type syphon. (Cat. No. SY14-S iron or SY14-B brass)

**SPECIFICATIONS: CASE & WINDOW** -Stainless Steel back flange with push-in Lexan window.  
**TUBE & SOCKET** -Phosphor bronze. Brass socket and 1/4" male NPT lower connection. Soft soldered connection.  
**DIAL** -White coated metal lithographed with black graduations lines and numerals, dual scale - psi & kPa.  
**MOVEMENT** -All brass construction, precision gear and pinion.  
**POINTER** - Slotted adjustable.  
**ACCURACY** -1% ANSI-ASME B40.1 Grade 1A.

## Series 4CTS



**SPECIFICATIONS: CASE & WINDOW** -Drawn stainless steel, with push-in Lexan window.  
**TUBE & SOCKET** -Phosphor bronze. Brass socket and 1/4" male NPT lower connection. Soft soldered connection.  
**DIAL** -White coated metal lithographed with black graduations lines and numerals, dual scale - psi & kPa.  
**MOVEMENT** All brass construction, precision gear and pinion.  
**POINTER** - Slotted adjustable.  
**ACCURACY** -1% ANSI-ASME B40.1 Grade 1A.

## Standard Graduations

### PRESSURE (psi) - Series TL

Range	Figure interval	Minor graduation
0-15	1	0.5
0-30	5	0.5
0-60	5	1.0
0-100	10	2.0
0-160	20	5.0
0-200	20	5.0
0-300	30	10.0
0-400♦	50	10.0
0-600♦	50	10.0

COMPOUND Range	Figure interval		Minor graduation	
	in Hg	psi	in Hg	psi
30"Hg-15psi♦	5	3	1	0.5
30"Hg-30psi♦	10	5	2	1
30"Hg-60psi♦	10	10	2	2
30"Hg-100psi♦	30	20	5	2

### VACUUM

Range	Figure interval	Minor graduation
0-30"Hg	5"Hg	0.5"Hg

♦ Ranges not available on Catalog No. TL15.

### PRESSURE (psi) - Series 4CTA and 4CTS

Range <sup>1</sup>	Figure interval	Minor graduation
0-15	1	0.2
0-30	5	0.5
0-60	5	1.0
0-100	10	1.0
0-160	20	2.0
0-200	20	2.0
0-300	50	5.0
0-400	50	5.0
0-600	50	10.0

COMPOUND Range	Figure interval		Minor graduation	
	in Hg	psi	in Hg	psi
30"Hg-15psi <sup>2</sup>	10	5	1	0.5
30"Hg-30psi	10	5	1	1
30"Hg-60psi	10	10	2	2
30"Hg-100psi	15	10	5	2
30"Hg-150psi <sup>2</sup>	30	20	2	2

### VACUUM

Range	Figure interval	Minor graduation
0-30"Hg	5"Hg	0.5"Hg

<sup>1</sup> All dial ranges available in dual scale - psi & kPa, psi & Kg/cm<sup>2</sup>. Ranges 15psi thru 200psi available dual scale - psi & Ft H<sub>2</sub>O.

<sup>2</sup> Ranges are not offered on 4CTA Gauges.

## Diaphragm Gauges



## Series DG25



The Weiss Series DG Gauges are used where accuracy is required in the measurement of pressures below 10 psi. This line of diaphragm gauges offers an instrument highly sensitive yet durably constructed. Utilizing a thin walled copper alloy, the diaphragm senses slight pressure or vacuum and expands or contracts. The action of the element is quickly and accurately indicated within 1.5% of full scale range.

The Weiss Diaphragm Gauge is an excellent choice for a wide variety of applications where the standard bourdon tube gauge cannot perform reliably. Some of the uses are filter monitoring, leak testers and LP gas.

**SPECIFICATIONS: CASE** - Black drawn steel, with twist lock polycarbonate window.

**DIAPHRAGM** - Copper alloy.

**SOCKET** - Brass, 1/4" NPT lower or center back connection.

**MOVEMENT** - Brass.

**DIAL** - White coated metal lithographed with black graduations lines and numerals.

**POINTER** - Balanced design, aluminum in black finish. **ACCURACY** - 1.5% of full scale range.

TO SPECIFY						
SERIES	SIZE	RANGE TYPE	CASE STYLE	NPT	MOUNT	RANGE
DG	2 1/2" 25	P3-Pressure V3-Vacuum C3-Combination	U-U Clamp	1/4"	LM* CBM**	— —
Ex: DG25P3 1/4" LM 0-10psi *LM - Lower Mount **CBM - Center Back Mount						

PRESSURE			COMBINATION		INNER SCALE		OUTER SCALE	
RANGE	GRADUATIONS	FIG. INTERVAL	IN. WATER OUTER SCALE	OZ. WATER INNER SCALE	GRADS	FIGURE INTERVAL	GRADS	FIGURE INTERVAL
0-3psi*	0.05	0.5	0-35	0-20	0.5	5.0	0.5	5.0
0-5 psi	0.1	1.0	0-15	0-9	0.2	1.0	0.2	3.0
0-10 psi	0.1	1.0	0-60	0-35	1.0	5.0	1.0	10.0
<b>inch/water</b>								
0-15	0.2	3.0						
0-30	0.5	5.0						
0-60	1.0	10.0						
0-100	1.0	10.0						
<b>oz.-sq. in.</b>			<b>VACUUM - in water vac.</b>					
0-10	0.1	1.0	<b>RANGE</b>	<b>GRADUATIONS</b>	<b>FIG. INTERVAL</b>			
0-15*	0.2	3.0	30-0	0.5	5.0			
0-30	1.0	5.0	60-0	1.0	10.0			
0-100	1.0	10.0	100-0	1.0	10.0			

\*Lower connection only.

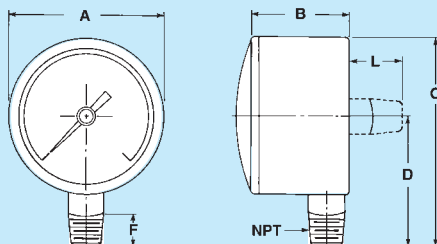

LOWER AND CENTER BACK CONNECTION

SERIES		A	B	C	D	F	L	NPT
DG25	INCH	2.64	1.83	2.62	55.8	.5	.88	1/4"
	MM	67	46.5	66.5	2.2	12.7	22.3	

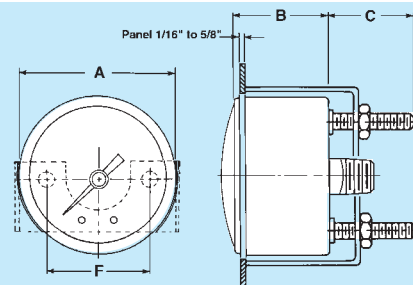

U CLAMP MOUNT - CENTER BACK CONNECTION

SERIES		A	B	C	F	Panel Hole	NPT
DG25	INCH	2.64	1.83	1.00	2.00	2.65	1/4"
	MM	67	46.5	25.4	50.8	67.3	

## Series TL

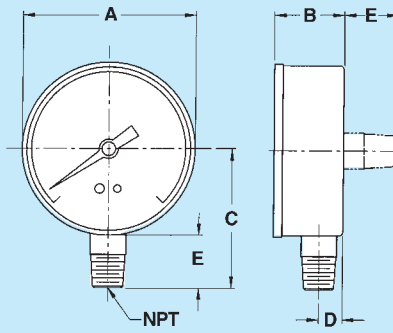

LOWER AND CENTER BACK CONNECTION

DIAL SIZE		A	B	C	D	E	NPT
1 1/2"	(IN.)	1.65	.91	1.47	.34	.64	1/8"
2"		2.03	1.11	1.80	.39	.80	1/8 or 1/4"
2 1/2"		2.47	1.19	2.06	.40	.82	1/8 or 1/4"
3 1/2"		3.69	1.24	2.65	.44	.81	1/8 or 1/4"
4 1/2"		4.45	1.40	3.30	.50	1.06	1/4"

## Series 4CTS

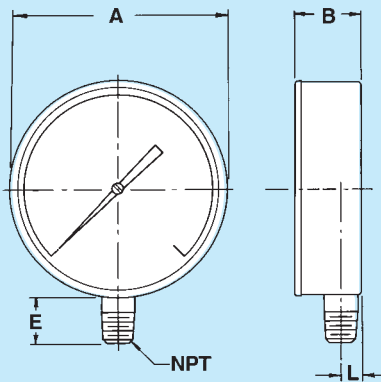

SERIES		A	B	E	L	NPT
4CTS	INCH	4.62	1.12	1.062	.437	1/4"
	MM	117.3	28.4	26.9	11.09	

## Series 4CTA

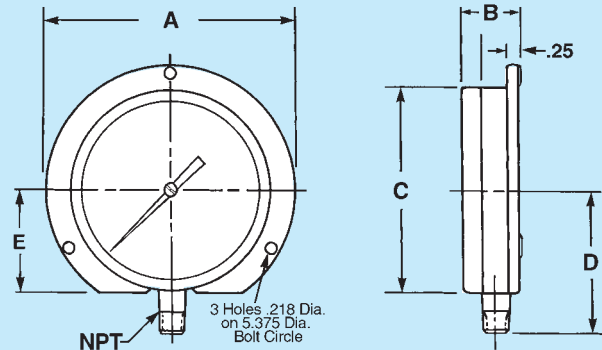

SERIES		A	B	C	D	E	NPT
4CTA	INCH	5.81	1.37	4.75	3.37	2.37	1/4"
	MM	147.5	34.9	120.6	85.7	60.3	