

TECUMSEH HERMETIC COMPRESSORS

TECUMSEH "AE" COMPRESSORS 5,800 - 6,500 BTUH

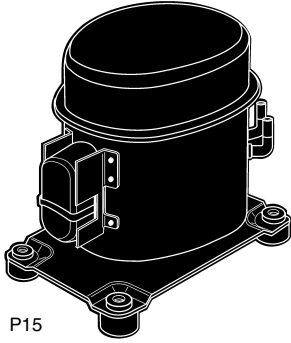

P15

- FOR ROOM AIR CONDITIONING COOLING
- EXTERNAL LINE BREAK OVERLOAD
- LOW NOISE AND VIBRATION LEVELS
- ADAPTABLE TO LIMITED CABINET SPACE
- LIGHTWEIGHT

COMPRESSOR MODEL P/N	COMPRESSOR BILL OF MATERIAL	CAPACITY* BTUH	APPLICATION	VOLTS-PHASE 60 HZ	COMPRESSOR P/N	RLA	LRA
AEA8458EXA	AE222AT-419-S7Y	5,800	AC	115-1	P031-0502	5.2	24.0
AEA8470EXA	AE240AT-404-S7Y	6,500	AC/HP	115-1	P031-0601	7.7	38.0

*CAPACITY RATINGS ARE FOR AIR CONDITIONING APPLICATIONS:

Evaporator Temperature 45° F, Condenser Temperature 130° F, Liquid Temperature 115° F, Return Gas Temperature 65° F, Ambient Temperature 95° F.

NOTES:

1. TECUMSEH High Efficiency Rating Conditions to be used only when "HE" follows capacity. Saturated Suction Temperature 49° F, Saturated Condenser Temperature 120° F, Sub-cooling Temperature 20° F, Actual Suction Gas Temperature 65° F.
2. DO NOT substitute a compressor rated at standard conditions with a TECUMSEH High Efficiency Compressor unless capacity ratings are adjusted.
When substituting FOR or substituting TO a "HE" compressor the capacity of the "HE" compressor MUST BE reduced 15%.

EXAMPLES:

1. Require a substitute for an 8000 BTU compressor:
Select P031-0902 rated 9400HE
 $9400 \times .85 = 7990$ BTUH
2. Require a substitute for P031-0902 rated 9400HE BTUH:
 $9400 \times .85 = 7990$ BTUH
Select an appropriate 8000 BTUH compressor to replace P031-0902.

TECUMSEH HERMETIC COMPRESSORS

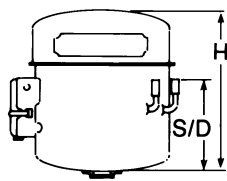

313B

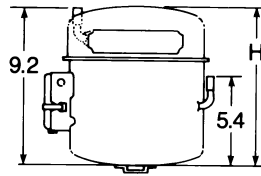

313C

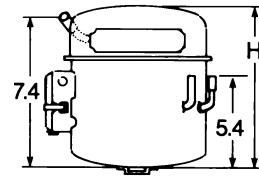

313D

(H) SHELL HEIGHT	SUCT. TUBE I.D.	DISC. TUBE I.D.	MTG. ARR.	COMPR. DWG.	START CAPACITOR		START RELAY P/N	RUN CAPACITOR	
					MFD/VOLTS	P/N		MFD/VOLTS	P/N
8.5	3/8	1/4	DB	313C	21-25/330	P281-2106	P283-9917	15/370	P291-1503
8.7	3/8	1/4	DB	313B	21-25/330	P281-2106	P283-9917	15/370	P291-1503

DB = DETACHABLE BASE

TECUMSEH MOUNTING PLATE KITS FOR TECUMSEH "AE & AK" COMPRESSORS

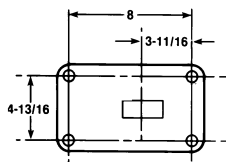

KA37BR017

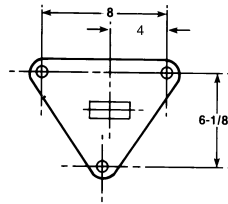

KA37BR018

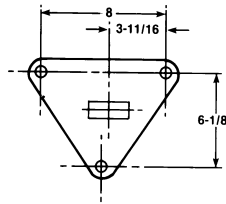

KA37BR020

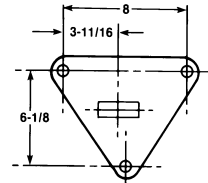

KA37BR010

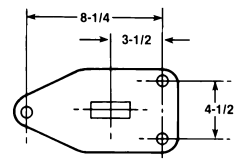

KA37BR015

DESCRIPTION	P/N
MOUNTING PLATE	KA37BR010
MOUNTING PLATE	KA37BR015
MOUNTING PLATE	KA37BR017
MOUNTING PLATE	KA37BR018
MOUNTING PLATE	KA37BR020

DESCRIPTION	P/N
SPRING PIN	KA38BR010
MOUNTING GROMMET	KA56TR052
GROMMET/SLEEVE	KA56TS022

TECUMSEH HERMETIC COMPRESSORS

TECUMSEH "AK" COMPRESSORS 7,000 - 15,000 BTUH

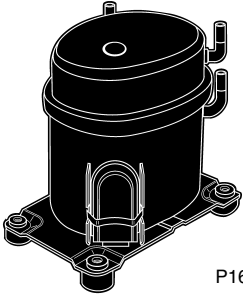

P16

- ROOM AIR CONDITIONING COOLING AND SPECIAL HEAT PUMP APPLICATIONS AS DETERMINED BY THE ORIGINAL EQUIPMENT MANUFACTURER
- EXTERNAL LINE BREAK OVERLOAD
- LOW NOISE AND VIBRATION LEVELS
- ADAPTABLE TO LIMITED CABINET SPACE

COMPRESSOR MODEL P/N	COMPRESSOR BILL OF MATERIAL	CAPACITY* BTUH	APPLICATION	VOLTS-PHASE	COMPRESSOR P/N	RLA	LRA
60 HZ MODELS							
AKA5470EXA	AK120AT-004-S7Y	7,000	AC/HP	115-1	P031-0701	7.1	35.0
AKA8475EXD	AK123ET-009-S7Y	7,500 HE	AC	208/230-1	P031-0721	2.8	15.9
AKA8475EXV	AK123JB-009-S7Y	7,500 HE	AC	265-1	P031-0791	2.6	12.3
AKA5483EXA	AK130AT-004-S7Y	8,300	AC/HP	115-1	P031-0801	9.0	43.0
AKA5483EXD	AK130ET-004-S7Y	8,300	AC/HP	208/230-1	P031-0821	4.4	21.3
AKA5483EXV	AK130JB-004-S7Y	8,300	AC	265-1	P031-0891	3.9	22.3
AKA8494EXD	AK145ET-009-S7Y	9,400 HE	AC	208/230-1	P031-0922	3.5	20.0
AKA8494EXV	AK145JB-009-S7Y	9,400 HE	AC	265-1	P031-0992	3.0	16.0
AKA5510EXV	AK100JB-004-S7Y	10,000	AC/HP	265-1	P031-1091	5.0	27.4
AKA5511EXA	AK110AT-004-S7Y	11,000	AC/HP	115-1	P031-1101	11.0	50.0
AKA8511EXA	AK149BT-009-S7Y	11,400	AC/HP	115-1	P031-1104	8.9	50.0
AKA5511EXD	AK110ET-004-S7Y	11,000	AC/HP	208/230-1	P031-1121	5.9	31.0
AKA8512EXD	AK151ET-009-S7Y	12,000 HE	AC	208/230-1	P031-1221	4.6	31.2
AKA5512EXV	AK111JB-004-S7Y	12,000	AC/HP	265-1	P031-1291	5.5	33.0
AKA8512EXV	AK151JB-009-S7Y	12,000 HE	AC/HP	265-1	P031-1292	4.2	27.0
AKA8513EXA	AK144AT-009-S7Y	13,500 HE	AC	115-1	P031-1302	9.5	50.0
AKA8513EXD	AK144ET-009-S7Y	13,500 HE	AC	208/230-1	P031-1324	5.8	31.0
AKA8513EXV	AK144JB-009-S7Y	13,500 HE	AC	265-1	P031-1392	4.7	27.0
AKA8515EXD	AK147ET-009-S7Y	15,000 HE	AC	208/230-1	P031-1524	6.2	36.0
AKA8515EXV	AK147JB-009-S7Y	15,000 HE	AC	265-1	P031-1593	5.4	33.0
50 HZ MODELS 6,900 - 11,300 BTUH							
AK5483E	AK130JT-004-S7Y	6,900	HP	220/240-1	P051-0731	4.0	21.2
AK5510E	AK100JT-004-S7Y	8,300	HP	220/240-1	P051-0831	5.2	25.6
AK5512E	AK111JT-004-S7Y	10,000	HP	220/240-1	P051-1031	6.0	31.0
AK8513E	AK144JT-009-S7Y	11,300	AC	220/240-1	P051-1132	4.8	26.3

*CAPACITY RATINGS ARE FOR AIR CONDITIONING APPLICATIONS:

Evaporator Temperature 45° F, Condenser Temperature 130° F, Liquid Temperature 115° F, Return Gas Temperature 65° F, Ambient Temperature 95° F.

NOTES:

1. TECUMSEH High Efficiency Rating Conditions to be used only when "HE" follows capacity. Saturated Suction Temperature 49° F, Saturated Condenser Temperature 120° F, Sub-cooling Temperature 20° F, Actual Suction Gas Temperature 65° F.
2. DO NOT substitute a compressor rated at standard conditions with a TECUMSEH High Efficiency Compressor unless capacity ratings are adjusted. When substituting FOR or substituting TO a "HE" compressor the capacity of the "HE" compressor MUST BE reduced 15%.

EXAMPLES:

1. Require a substitute for an 8000 BTUH compressor:
Select P031-0902 rated 9400HE
 $9400 \times .85 = 7990$ BTUH

2. Require a substitute for P031-0902 rated 9400HE BTUH:
 $9400 \times .85 = 7990$ BTUH
Select an appropriate 8000 BTUH compressor to replace P031-0902.

TECUMSEH HERMETIC COMPRESSORS

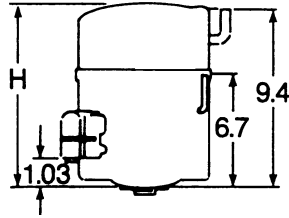

313A

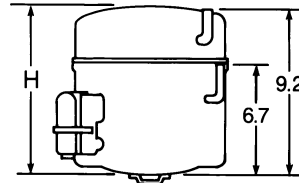

314A

(H) SHELL HEIGHT	SUCT. TUBE I.D.	DISC. TUBE I.D.	MTG. ARR.	COMPR. DWG.	START CAPACITOR		START RELAY P/N	RUN CAPACITOR	
					MFD/VOLTS	P/N		MFD/VOLTS	P/N
9.0	3/8	1/4	DB	314A	21-25/330	P281-2106	P283-9917	15/370	P291-1503
9.4	3/8	1/4	DB	313A	21-25/330	P281-2106	P283-9917	15/370	P291-1503
9.4	3/8	1/4	DB	313A	21-25/330	P281-2106	P283-9917	15/370	P291-1503
9.0	3/8	1/4	DB	314A	21-25/330	P281-2106	P283-9917	15/370	P291-1503
9.0	3/8	1/4	DB	314A	21-25/330	P281-2106	P283-9917	15/370	P291-1503
9.4	3/8	1/4	DB	314A	21-25/330	P281-2106	P283-9917	15/370	P291-1503
9.4	3/8	5/16	DB	313A	21-25/330	P281-2106	P283-9917	15/370	P291-1503
9.4	3/8	1/4	DB	313A	21-25/330	P281-2106	P283-9917	15/370	P291-1503
9.0	3/8	1/4	DB	314A	21-25/330	P281-2106	P283-9917	15/370	P291-1503
9.0	3/8	1/4	DB	314A	21-25/330	P281-2106	P283-9917	25/370	P291-2503
8.8	3/8	1/4	DB	314A	—	P281-2106	P283-9917	25/370	P291-2503
9.0	3/8	1/4	DB	314A	21-25/330	P281-2106	P283-9917	15/370	P291-1503
9.4	3/8	1/4	DB	313A	21-25/330	P281-2106	P283-9917	25/370	P291-2503
9.0	3/8	1/4	DB	314A	21-25/330	P281-2106	P283-9928	15/440	P291-1504
9.4	3/8	1/4	DB	313A	21-25/330	P281-2106	P283-9917	15/370	P291-1503
9.4	3/8	1/4	DB	313A	43-53/320	P281-4306	P283-9917	25/370	P291-2503
9.4	3/8	1/4	DB	313A	43-53/320	P281-4306	P283-9917	15/370	P291-1503
9.4	3/8	1/4	DB	313A	43-53/320	P281-4306	P283-9917	15/370	P291-1503
9.4	3/8	1/4	DB	313A	21-25/330	P281-2106	P283-9921	25/370	P291-2503
9.4	3/8	1/4	DB	313A	21-25/330	P281-2106	P238-9928	15/440	P291-1504
9.2	3/8	1/4	DB	314A	21-25/330	P281-2106	P238-9915	15/370	P291-1503
9.2	3/8	1/4	DB	314A	21-25/330	P281-2106	P283-9917	20/370	P291-2003
9.2	3/8	1/4	DB	314A	21-25/330	P281-2106	P283-9917	20/370	P291-2003
8.8	3/8	1/4	DB	313A	21-25/330	P281-2106	P283-9917	15/370	P291-1503

DB = DETACHABLE BASE
See page 35

TECUMSEH HERMETIC COMPRESSORS

TECUMSEH "AJ" COMPRESSORS 13,200 - 19,000 BTUH

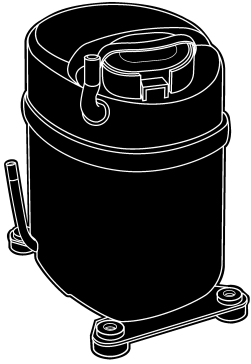

- RAC AND SMALL CENTRAL AIR CONDITIONING ONLY
- EXTERNAL LINE BREAK OVERLOAD
- LOW NOISE AND VIBRATION LEVELS
- ADAPTABLE TO LIMITED CABINET SPACE

COMPRESSOR MODEL P/N	COMPRESSOR BILL OF MATERIAL	CAPACITY* BTUH	APPLICATION	VOLTS-PHASE	COMPRESSOR P/N	RLA	LRA
60 HZ MODELS							
AJB5513EXD	AJ540FT-124-S7Y	13,200	AC	208/230-1	P031-1325 ♦	7.5	37.5
AJB5513EXD	AJ540FT-356-S7Y	13,200	AC	208/230-1	P031-1326	7.5	37.5
AJB5515EXD	AJ600FT-120-S7Y	15,000	AC	208/230-1	P031-1521	8.5	41.0
AJB5515EXD	AJ600FT-352-S7Y	15,000	AC	208/230-1	P031-1525	8.5	41.0
AJB5515EXV	AJ600JB-120-S7Y	15,000	AC	265-1	P031-1591	7.4	42.0
AJA5517EXD	AJ210FT-206-S7Y	17,000	AC	208/230-1	P031-1721	11.0	55.0
AJA5518EXV	AJ200JB-206-S7Y	17,000	AC	265-1	P031-1791	10.5	54.0
AJA5519EXD	AJ220FT-206-S7Y	19,000	AC	208/230-1	P031-1921	11.6	57.0
AJA5519EXD	AJ220FT-349-S7Y	19,000	AC	208/230-1	P031-1927	10.2	57.0
AJA5519EXV	AJ220JB-206-S7Y	19,000	AC	265-1	P031-1991	12.0	57.0
50 HZ MODELS 12,500 - 15,400 BTUH							
AJ5515F	AJ600JT-205-S7Y	12,500	A/C	220/240-1	P051-1231	8.0	39.0
AJ5515F	AJ600JT-299-S7Y	12,500	A/C	220/240-1	P051-1233	8.0	39.0
AJ5517E	AJ210JT-206-S7Y	14,000	A/C	220/240-1	P051-1432	10.2	51.0
AJ5517E	AJ210JT-349-S7Y	14,000	A/C	220/240-1	P051-1433	11.0	51.0
AJ5518E	AJ200KT-353-S7Y	15,000	A/C	220/240-1	P051-1531	11.3	51.0
AJ5518E	AJ200KT-206-S7Y	15,400	A/C	220/240-1	P051-1532	11.3	51.0

*CAPACITY RATINGS ARE FOR AIR CONDITIONING APPLICATIONS:

Evaporator Temperature 45° F, Condenser Temperature 130° F, Liquid Temperature 115° F, Return Gas Temperature 65° F, Ambient Temperature 95° F.

♦ = Superseded - Limited to stock on hand 10/00.

NOTES:

1. TECUMSEH High Efficiency Rating Conditions to be used only when "HE" follows capacity. Saturated Suction Temperature 49° F, Saturated Condenser Temperature 120° F, Sub-cooling Temperature 20° F, Actual Suction Gas Temperature 65° F
2. DO NOT substitute a compressor rated at standard conditions by a TECUMSEH High Efficiency Compressor unless capacity ratings are adjusted. When substituting FOR or substituting TO a "HE" compressor the capacity of the "HE" compressor MUST BE reduced 15%.

EXAMPLES:

1. Require a substitute for an 8000 BTU compressor:
Select P031-0902 rated 9400HE
 $9400 \times .85 = 7990$ BTUH

2. Require a substitute for P031-0902 rated 9400HE BTUH:
 $9400 \times .85 = 7990$ BTUH Select an appropriate
8000 BTUH compressor to replace P031-0902.

TECUMSEH HERMETIC COMPRESSORS

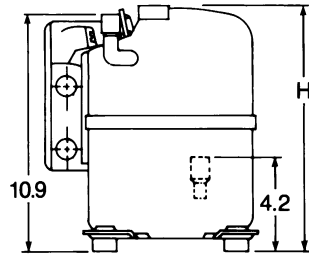

301A

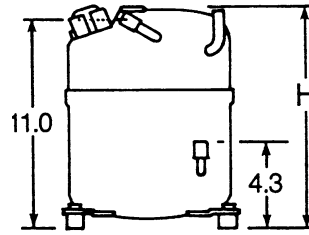

304D

(H) SHELL HEIGHT	SUCT. TUBE I.D.	DISC. TUBE I.D.	MTG. ARR.	COMPR. DWG.	START CAPACITOR		START RELAY P/N	RUN CAPACITOR	
					MFD/VOLTS	P/N		MFD/VOLTS	P/N
11.0	3/8	1/4	B	301A	21-25/330	P281-2106	P283-9917	17/370	P291-1753
11.0	3/8	1/4	C2	301A	21-25/330	P281-2106	P283-9917	17/370	P291-1753
10.8	1/2	5/16	B	301A	21-25/330	P281-2106	P283-9917	20/370	P291-2003
11.0	1/2	3/8	C2	301A	21-25/330	P281-2106	P283-9917	20/370	P291-2003
10.8	1/2	5/16	B	301A	21-25/330	P281-2106	P283-9928	20/440	P291-2004
11.1	1/2	5/16	B	301A	21-25/330	P281-2106	P283-9917	25/370	P291-2503
11.1	1/2	5/16	B	301A	21-25/330	P281-2106	P283-9928	25/370	P291-2503
11.3	1/2	5/16	B	301A	75-90/330	P281-7506	P283-9915	25/370	P291-2503
11.0	1/2	1/3	C2	301A	21-25/330	P281-2106	P283-9917	25/370	P291-2503
11.4	1/2	5/16	B	301A	21-25/330	P281-2106	P283-9923	25/440	P291-2504
10.9	1/2	5/16	B	301A	21-25/330	P281-2106	P283-9917	20/370	P291-2003
10.9	1/2	5/16	C2	304D	21-25/330	P281-2106	P283-9917	45/370	P291-4503
11.4	1/2	3/8	B	301A	21-25/330	P281-2106	P283-9917	25/370	P291-2503
11.3	1/2	3/8	C2	304D	21-25/330	P281-2106	P283-9917	25/370	P291-2503
11.3	1/2	3/8	C2	304D	21-25/330	P281-2106	HN61HB490	30/370	P291-3003
11.4	1/2	5/16	B	301A	21-25/330	P281-2106	P283-9919	25/370	P291-2503

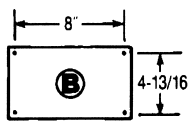

bpb4

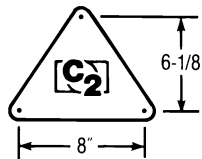

bpc2

TECUMSEH HERMETIC COMPRESSORS

TECUMSEH "AW" COMPRESSORS 15,500 - 32,000 BTUH

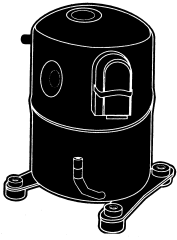

P19

- FOR HEAT PUMP AND AIR CONDITIONING DUTY
- INTERNAL LINE BREAK OVERLOAD
- INTERNAL PRESSURE RELIEF VALVE

COMPRESSOR MODEL P/N	COMPRESSOR BILL OF MATERIAL	CAPACITY* BTUH	APPLICATION	VOLTS-PHASE 60 HZ	COMPRESSOR P/N	RLA	LRA
AWG5515EXN	AW700ET-1-S7Y	15,500	AC/HP	208/230-1	P031-1527	7.3	43.0
AWF5516EVA	AW500JT-089	16,700	AC/HP	265-1	P031-1693	5.8	41.0
AWF5517EVA	AW701JT-094-S7Y	17,000	AC/HP	265-1	P031-1794	6.8	45.0
AWF5517EXN	AW501ET-088-S7Y	17,000	AC/HP	208/230-1	P031-1724	6.9	48.0
AWF5518EVA	AW502JT-089-S7Y	18,000	AC/HP	265-1	P031-1894	6.7	47.0
AWF5519EXN	AW503ET-088-S7	19,000	AC/HP	208/230-1	P031-19210	7.7	48.3
AWG5519EXN	AW702ET-093-S7Y	19,000	AC/HP	208/230-1	P031-1928	8.6	52.0
AWG5519EXN	AW702ET-103-S7Y	19,000	AC/HP	208/230-1	P031-1929	8.6	52.0
AWG5519EVA	AW702JT-093-S7Y	19,100	AC/HP	265-1	P031-1993	7.5	45.0
AWF5522EXT	AW504RT-112	21,300	AC/HP	200/230-3	P031-2151	5.6	50.0
AWF5522EXG	AW504TT-091	21,300	AC/HP	460-3	P031-2171	2.9	25.0
AWF5522EVA	AW504JT-089-S7Y	21,800	AC/HP	265-1	P031-2191	7.8	58.0
AWF5522EXN	AW504ET-089-S7Y	22,000	AC/HP	208/230-1	P031-2224	8.8	60.0
AWF5524EXN	AW505ET-088-S7Y	24,000	AC/HP	208/230-1	P031-2429	10.0	60.0
AWF5524EXG	AW505TT-091-S7Y	24,400	AC/HP	460-3	P031-2472	3.2	25.0
AWF5524EXT	AW505RT-089-S7Y	24,700	AC/HP	208/230-3	P031-2453	6.4	50.0
AWF5542EVA	AW505JT-089	24,700	AC/HP	265-1	P031-2493	8.9	58.0
AWG5524EVA	AW705JT-103-S7Y	24,700	AC/HP	265-1	P031-2492	9.2	54.0
AWF5528EXT	AW507RT-088-S7Y	28,000	AC/HP	200/230-3	P031-2854	7.6	63.0
AWF5528EXG	AW507TT-091-S7Y	28,000	AC/HP	460-3	P031-2872	3.8	36.0
AWG5528EXN	AW706ET-093-S7Y	28,400	AC/HP	208/230-1	P031-2824	9.5	73.0
AWF5528EXN	AW507ET-088-S7Y	28,400	AC/HP	208/230-1	P031-2825	11.2	69.4
AWF5528EVA	AW507JT-089-S7Y	28,400	AC/HP	265-1	P031-2892	10.5	65.0
AWG5530EXN	AW707ET-103-S7Y	30,200	AC/HP	208/230-1	P031-3025	14.4	90.0
AWG5532EXN	AW708ET-093-S7Y	31,500	AC/HP	208/230-1	P031-3124	9.5	90.0
AWF5532EXT	AW509RT-088-S7Y	31,500	AC/HP	200/230-3	P031-3153	8.6	63.4
AWF5532EXT	AW509ET-088-S7Y	32,000	AC/HP	208/230-1	P031-3223	13.4	84.0

*CAPACITY RATINGS ARE FOR AIR CONDITIONING APPLICATIONS:

Evaporator Temperature 45° F, Condenser Temperature 130° F, Liquid Temperature 15° F, Return Gas Temperature 65° F, Ambient Temperature 95° F.

NOTE: REFER TO FOLLOWING CROSS-REFERENCE FOR SELECTION OF CRANKCASE HEATERS FOR TECUMSEH.

COMPRESSOR SERIES	CRANKCASE PART NUMBER
AW-G; AW-E; AW-F	50QP680001
AV-G; AG-E	50QE680002
AV-E; AV-H	HT 660 001

TECUMSEH HERMETIC COMPRESSORS

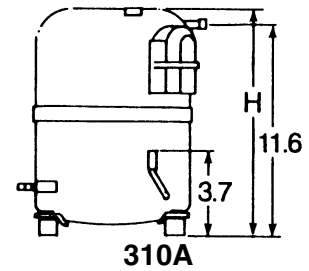
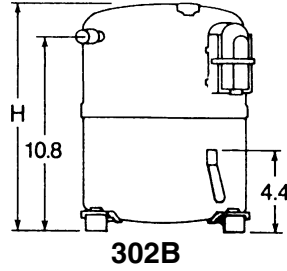
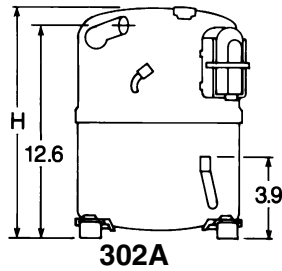

(H) SHELL HEIGHT	SUCT. TUBE I.D.	DISC. TUBE I.D.	MTG. ARR.	COMPR. DWG.	START CAPACITOR		START RELAY P/N	RUN CAPACITOR	
					MFD/VOLTS	P/N		MFD/VOLTS	P/N
13.1	5/8	3/8	A	302B	145-175/330	P281-1456	P283-9914	20/370	P291-2003
13.1	3/4	3/8	A	310A	72-88/330	P281-7206	P283-9930	25/440	P291-2504
13.1	3/4	3/8	A	302B	—	P281-8806	P283-9918	25/370	P291-2503
13.1	3/4	3/8	A	310A	88-108/330	P281-8806	P283-9924	35/370	P291-3503
13.1	3/4	3/8	A	310A	—	P281-7206	P283-9924	35/440	P291-3574
13.1	3/4	3/8	A	310A	88-108/330	P281-8806	P283-9924	35/370	P291-3503
13.1	3/4	3/8	A	302B	—	P281-1456	P283-9913	25/370	P291-2503
13.1	5/8	3/8	A	302A	145-175/330	P281-1456	P283-9913	25/370	P291-2503
13.1	5/8	3/8	A	302A	88-108/330	P281-8806	—	25/370	P291-2503
13.1	3/4	3/8	A	310A	—	—	—	—	—
13.1	3/4	3/8	A	310A	—	—	—	—	—
13.1	3/4	3/8	A	302A	88-108/330	P281-8806	P283-9924	35/370	P291-3503
13.1	3/4	3/8	A	310A	145-175/330	P281-1456	P283-9936	35/370	P291-3503
13.1	3/4	3/8	A	310A	145-175/330	P281-1456	P283-9913	35/370	P291-3503
13.1	3/4	3/8	A	310A	—	—	—	—	—
13.1	3/4	3/8	A	310A	—	N/R	N/R	—	N/R
13.1	3/4	3/8	A	310A	88-108/330	P281-8806	P283-9919	35/440	P291-3554
13.1	5/8	3/8	A	302A	88-108/330	P281-8806	N/A	35/440	P291-3504
13.1	3/4	3/8	A	310A	—	N/R	N/R	—	N/R
13.1	3/4	3/8	A	310A	—	N/R	N/R	—	N/R
13.1	3/4	3/8	A	302B	88-108/330	P281-8806	P283-9924	35/370	P291-3503
13.1	3/4	3/8	A	310A	P281-1456	P283-9924	P291-4503	45/370	P291-4503
13.1	3/4	3/8	A	310A	88-108/330	P281-8806	—	35/370	P291-3503
13.1	5/8	3/8	A	302A	145-175/330	P281-1456	P283-9924	45/370	P291-4503
13.1	3/4	3/8	A	302B	145-175/330	P281-1456	P283-9924	45/370	P291-4503
13.1	3/4	3/8	A	310A	—	N/R	N/R	—	N/R
13.1	3/4	3/8	A	310A	—	P281-1456	P283-9924	45/370	P291-4503

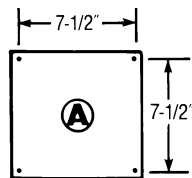

bpa

TECUMSEH HERMETIC COMPRESSORS

TECUMSEH "AW" COMPRESSORS 15,700 - 25,070 BTUH (50 HZ MODELS)

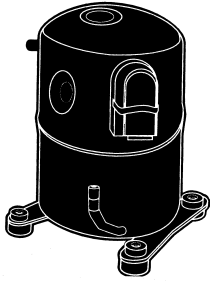

P19

- FOR HEAT PUMP AND AIR CONDITIONING DUTY
- INTERNAL LINE BREAK OVERLOAD
- INTERNAL PRESSURE RELIEF VALVE

COMPRESSOR MODEL P/N	COMPRESSOR BILL OF MATERIAL	CAPACITY* BTUH	APPLICATION	VOLTS-PHASE 50 HZ	COMPRESSOR P/N	RLA	LRA
AWG5519EVA	AW702JT-100-S7Y	15,700	AC/HP	220/240-1	P051-1534	7.7	45.0
AW5522E	AW104KT-029-S7Y	18,200	AC/HP	220/240-1	P051-1834 ♦	9.4	51.0
AWG5522EVA	AW704JT-103	18,300	AC/HP	220/240-1	P051-1837	8.7	51.0
AW5524E	AW105KT-025-S7Y	20,650	AC/HP	220/240-1	P051-2033	9.7	54.0
AW5528E	AW101KT-029-S7Y	23,300	AC/HP	220/240-1	P051-2331	11.3	65.0
AW5530E	AW102KT-014-S7Y	25,070	AC/HP	220/240-1	P051-2534	13.0	82.0
AW5522EVA	AW704JT-094-S7Y	18,300	AC/HP	220/240-1	P051-1839	8.7	51.0

*CAPACITY RATINGS ARE FOR AIR CONDITIONING APPLICATIONS:

Evaporator Temperature 45° F, Condenser Temperature 130° F, Liquid Temperature 115° F, Return Gas Temperature 65° F, Ambient Temperature 95° F.

♦ = Limited to stock on hand 10/02.

TECUMSEH HERMETIC COMPRESSORS

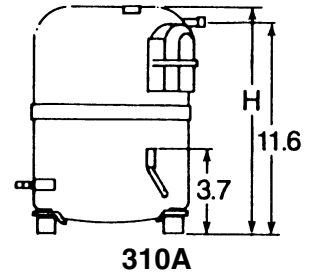
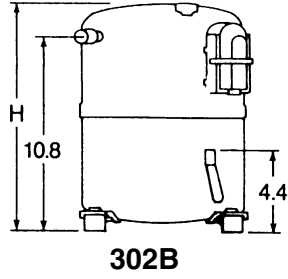
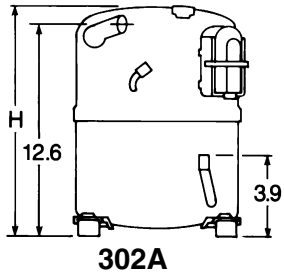

(H) SHELL HEIGHT	SUCT. TUBE I.D.	DISC. TUBE I.D.	MTG. ARR.	COMPR. DWG.	START CAPACITOR		START RELAY P/N	RUN CAPACITOR	
					MFD/VOLTS	P/N		MFD/VOLTS	P/N
13.1	1/2	5/16	A	302B	88-108/330	P281-8806	P283-9918	25/370	P291-2503
13.1	5/8	3/8	A	302A	88-108/330	P281-8806	P283-9915	25/370	P291-2503
13.1	5/8	3/8	A	302A	88-108/330	P281-8806	P283-9918	25/370	P291-2503
13.1	1/2	5/16	A	302B	88-108/330	P281-8806	P283-9915	35/370	P291-3503
13.2	5/8	3/8	A	302A	88-108/330	P281-8806	P283-9915	35/370	P291-3503
13.1	3/4	3/8	A	310A	88-108/330	P281-8806	P283-9915	45/370	P291-4503
13.1	3/4	3/8	A	302B	88-108/330	P281-8806	P283-9918	25/370	P291-2503

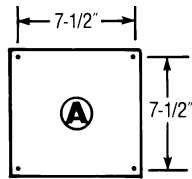

bpa

TECUMSEH HERMETIC COMPRESSORS

TECUMSEH "AV" COMPRESSORS 31,460 - 57,500 BTUH



P22

- * FOR HEAT PUMP AND AIR CONDITIONING DUTY
- * HIGH EFFICIENCY
- * SOLID STATE CRANKCASE HEATER
- * REPLACES MANY "AH" MODELS
- * EXPANDED CAPACITY RANGE

COMPRESSOR MODEL P/N	COMPRESSOR BILL OF MATERIAL	CAPACITY* BTUH	APPLICATION	VOLTS-PHASE	COMPRESSOR P/N	RLA	LRA
60 HZ MODELS							
AVA5532EXN	AV113ET-026-S7Y	31,460	AC/HP	208/230-1	P031-3123	14.5	78.0
AVA5532EXV	AV113JB-026-S7Y	31,460	AC/HP	265-1	P031-3191	12.2	73.8
AVA5532EXT	AV114RT-027-S7Y	31,460	AC/HP	200/230-3	P031-3152	8.9	59.5
AVA5532EXG	AV114TT-017-S7Y	31,460	AC/HP	460-3	P031-3272	4.4	32.8
AVA5532EXN	AV113ET-002-S7Y	32,000	AC/HP	208/230-1	P031-3221	14.5	78.0
AVA5532EXV	AV113JB-002-S7Y	32,000	AC/HP	265-1	P031-3291	12.2	73.8
AVA5532EXT	AV114RT-016-S7Y	32,000	AC/HP	200/230-3	P031-3252	8.7	59.5
AVB5535EXG	AV125TT-043-S7Y	34,500	AC/HP	460-3	P031-3471	4.6	32.8
AVB5535EXH	AV125VT-043-S7Y	34,500	AC/HP	575-3	P031-3481	4.0	13.1
AVA5535EXN	AV122ET-004-S7Y	34,600	AC/HP	208/230-1	P031-3523	15.7	88.0
AVA5535EXT	AV123RT-027-S7Y	35,200	AC/HP	208/230-3	P031-3551	9.7	65.1
AVB5535EXT	AV125RT-046-S7Y	35,000	AC/HP	208/230-3	P031-3552	9.2	65.1
AVB5535EXN	AV125ET-041-S7Y	35,200	AC/HP	208/230-1	P031-3522	14.2	86.7
AVA5538EXN	AV133ET-030-S7Y	37,750	AC/HP	208/230-1	P031-3822	17.2	95.0
AVC5538EXN	AV135ET-005-S7Y	38,000	AC/HP	208/230-1	P031-3823	17.2	97.6
AVB5538EXN	AV136ET-041-S7Y	38,000	AC/HP	208/230-1	P031-3824	15.4	97.6
AVA5538EXG	AV134TT-013-S7Y	38,400	AC/HP	460-3	P031-3872	8.0	37.7
AVA5538EXT	AV134RT-012-S7Y	38,000	AC/HP	208/230-3	P031-3854	10.8	73.4
AVB5538EXT	AV136RT-046-S7Y	37,500	AC/HP	208/230-3	P031-3855	12.9	73.4
AVA5538EXC	AV133JB-003-S7Y	38,400	AC/HP	265-1	P031-3892	17.2	95.0
AVA5538EXG	AV134TT-036-S7Y	38,400	AC/HP	460-3	P031-3873	5.3	37.3
AVB5542EXT	AV147RT-046-S7Y	41,500	AC/HP	200/230-3	P031-4151	13.3	73.4
AVB5542EXG	AV147TT-043-S7Y	41,500	AC/HP	460-3	P031-4171	5.65	37.7
AVB5542EXH	AV147VT-043-S7Y	41,500	AC/HP	575-3	P031-4181	4.4	31.0
AVC5542EXN	AV146ET-005-S7Y	42,000	AC/HP	208/230-1	P031-4221	18.3	107.4
AVB5542EXN	AV147ET-041-S7Y	42,000	AC/HP	208/230-1	P031-4222	17.1	107.4
AVA5542EXT	AV145RT-012-S7Y	42,000	AC/HP	200/230-3	P031-4251	12.0	74.0
AVA5542EXG	AV145TT-013-S7Y	42,000	AC/HP	460-3	P031-4271	5.9	37.0
AVA5546EXN	AV168ET-024-S7Y	45,700	AC/HP	208/230-1	P031-4622	21.5	116.0
AVC5546EXN	AV177ET-005-S7Y	46,000	AC/HP	208/230-1	P031-4623	20.4	110.0
AVA5546EXT	AV169RT-012-S7Y	46,000	AC/HP	208/230-3	P031-4652	13.3	92.0
AVA5546EXG	AV169TT-013-S7Y	46,000	AC/HP	460-3	P031-4672	10.9	46.0
AVB5549EXH	AV178VT-043-S7Y	48,800	AC/HP	575-3	P031-4981	5.4	44.0
AVB5549EXG	AV178TT-043-S7Y	48,000	AC/HP	400/460-3	P031-4873	6.7	46.0
AVB5549EXT	AV178RT-046-S7Y	48,500	AC/HP	208/230-3	P031-4951	13.5	92.0
AVB5549EXN	AV178ET-041-S7Y	49,000	AC/HP	208/230-1	P031-4921	20.5	110.0
AVB5558EXT	AV190RT-045-S7Y	57,000	AC/HP	200/230-3	P031-5751	15.7	100.0
AVB5558EXG	AV190TT-045-S7Y	57,000	AC/HP	460-3	P031-5771	7.8	55.0
AVB5558EXH	AV190VT-045-S7Y	57,000	AC/HP	575-3	P031-5781	6.3	44.0
AVB5558EXN	AV190ET-047-S7Y	57,500	AC/HP	208/230-1	P031-5721	24.8	141.0
50 HZ MODEL 38,750 BTUH							
AVA5546EXC	AV168JT-005-S7Y	38,750	AC/HP	220/240-1	P051-3831	18.4	102.0

*CAPACITY RATINGS ARE FOR AIR CONDITIONING APPLICATIONS:

Evaporator Temperature 45° F, Condenser Temperature 130° F, Liquid Temperature 115° F, Return Gas Temperature 65° F, Ambient Temperature 95° F.

TECUMSEH HERMETIC COMPRESSORS

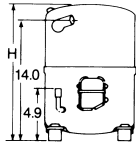

306A

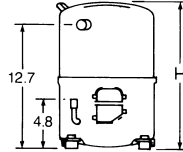

306B; 306C W/C.C.H.

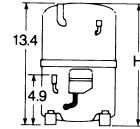

307A

(H) SHELL HEIGHT	SUCT. TUBE I.D.	DISC. TUBE I.D.	MTG. ARR.	COMPR. DWG.	START CAPACITOR		START RELAY P/N	RUN CAPACITOR	
					MFD/VOLTS	P/N		MFD/VOLTS	P/N
13.9	7/8	1/2	A	306B	88/105/250	P281-8805	P283-9919	35/370	P291-3503
13.9	7/8	1/2	A	306B	88/108/330	P281-8806	P283-9919	35/440	P291-3504
13.9	7/8	1/2	A	306B	—	—	—	—	—
14.6	3/4	3/8	A	307A	—	—	—	—	—
14.8	3/4	3/8	A	306A	88-108/250	P281-8805	P283-9924	35/370	P291-3503
14.2	3/4	3/8	A	307A	33-108/330	P281-8806	P283-9924	35/440	P291-3554
14.5	3/4	1/2	A	307A	—	—	—	—	—
13.9	7/8	1/2	A	306B	—	—	—	—	—
13.9	7/8	1/2	A	306B	—	—	—	—	—
14.9	3/4	3/8	A	307A	—	—	—	40/370	P291-4003
15.0	3/4	3/8	A	307A	—	—	—	—	—
13.9	7/8	1/2	A	306B	—	—	—	—	—
13.9	7/8	1/2	A	306B	88/108/330	P281-8806	P283-9924	45/370	P291-4503
15.0	7/8	1/2	A	306C	72-88/330	P281-7206	P283-9924	35/440	P291-3504
15.0	7/8	1/2	A	306A	72-88/330	P281-7206	P283-9924	35/440	P291-3504
13.9	7/8	1/2	A	306C	—	P281-1356	P283-9913	45/440	P291-4554
14.3	7/8	1/2	A	307A	—	—	—	—	—
14.5	7/8	1/2	A	307A	—	—	—	—	—
13.9	7/8	1/2	A	306C	189-227/330	P281-1896	P283-9914	—	—
15.3	7/8	1/2	A	307A	72-88/330	P281-7206	P283-9914	35/440	P291-3504
14.5	7/8	1/2	A	306C	—	—	—	—	—
13.9	7/8	1/2	A	306B	—	—	—	—	—
13.9	7/8	1/2	A	306B	—	—	—	—	—
13.9	7/8	1/2	A	306B	—	—	—	—	P291-4554
14.4	7/8	1/2	A	306A	72-88/330	P281-7206	P283-9924	45/440	P291-4004
13.9	7/8	1/2	A	306C	72/88/330	P281-7206	P283-9921	45/440	P291-4554
14.4	7/8	1/2	A	307A	—	—	—	—	—
14.4	7/8	1/2	A	306A	—	—	—	—	—
14.3	7/8	1/2	A	306A	72-88/330	P281-7206	P283-9924	40/440	P291-4004
13.9	7/8	1/2	A	307A	72-88/330	P281-7206	P283-9924	45/440	P291-4504
14.4	7/8	1/2	A	306A	—	—	—	—	—
14.4	7/8	1/2	A	306A	—	—	—	—	—
13.9	7/8	1/2	A	306C	—	—	—	—	—
13.9	7/8	1/2	A	306B	—	—	—	—	—
14.5	7/8	1/2	A	306C	—	—	—	—	—
14.5	7/8	1/2	A	306B	88/108/330	P281-8806	P283-9915	45/440	P291-4554
13.9	7/8	1/2	A	306B	—	—	—	—	—
13.9	7/8	1/2	A	306B	—	—	—	—	—
13.9	7/8	1/2	A	306B	—	—	—	—	—
13.9	7/8	1/2	A	306B	20 OHM	HC95XX020	N/R	45/440	P291-4554
14.4	7/8	1/2	A	307A	135-155/330	P281-1356	P283-9915	40/440	P291-4004

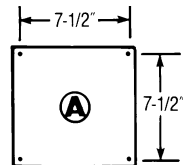

bpa

TECUMSEH HERMETIC COMPRESSORS

TECUMSEH "SF" COMPRESSORS 72,000 - 127,000 BTUH

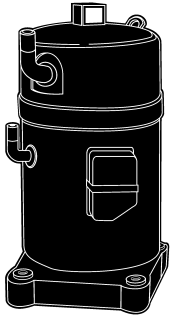

P23

- "QUADRO-FLEX MODEL"
- HIGH PRESSURE HOUSING
- NO CRANKCASE HEATER REQUIRED
- DIRECT SUCTION FLOW INTO CYLINDER ADDS TO HIGH EFFICIENCY
- FACTORY INSTALLED SUCTION SCREEN

COMPRESSOR MODEL P/N	COMPRESSOR BILL OF MATERIAL	CAPACITY* BTUH	APPLICATION	VOLTS-PHASE 60 HZ	COMPRESSOR P/N	RLA	LRA
SFA5572EXH	SF107VT-009-S7Y	72,000	AC/HP	575-3	P031-7281 ♦	7.6	58.5
SFA5594EXH	SF110VT-010-S7Y	93,000	AC/HP	575-3	P031-9382 ♦	10.4	78.4
SFA5611EXH	SF101VT-010-S7Y	107,000	AC/HP	575-3	P031-9983 ♦	11.4	78.4
SFA5612EXN	SF103VT-010-S7Y	127,000	AC/HP	575-3	P031-9984	15.2	111.0

*CAPACITY RATINGS ARE FOR AIR CONDITIONING APPLICATIONS:

Evaporator Temperature 45° F, Condenser Temperature 130° F, Liquid Temperature 115° F, Return Gas Temperature 65° F, Ambient Temperature 95° F.

♦ = Superseded - Limited to stock on hand 09/01.

TECUMSEH HERMETIC COMPRESSORS

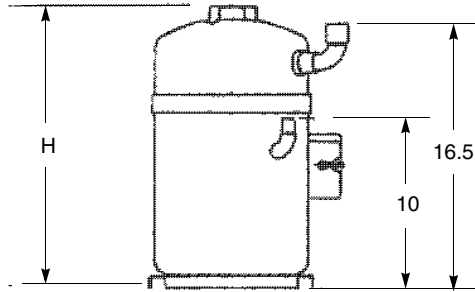

316A

(H) SHELL HEIGHT	SUCT. TUBE I.D.	DISC. TUBE I.D.	MTG. ARR.	COMPR. DWG.	START CAPACITOR		START RELAY P/N	RUN CAPACITOR	
					MFD/VOLTS	P/N		MFD/VOLTS	P/N
17.4	1-1/8	5/8	A	316A	—	—	—	—	—
17.4	1-3/8	3/4	A	316A	—	—	—	—	—
17.4	1-3/8	3/4	A	316A	—	—	—	—	—
17.4	1-3/8	3/4	A	316A	—	—	—	—	—

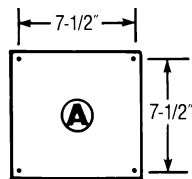

bpa

TECUMSEH HERMETIC COMPRESSORS

TECUMSEH "AG" COMPRESSORS 46,000 - 71,280 BTUH

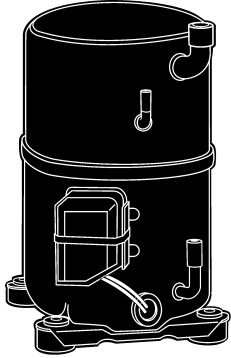

P24

- FOR HEAT PUMP OR CENTRAL AIR CONDITIONING DUTY
- INTERNAL LINE BREAK OVERLOAD
- INTERNAL PRESSURE RELIEF VALVE
- LOW NOISE AND VIBRATION LEVELS
- REPLACES "CL" MODELS AND OTHER BRANDS

COMPRESSOR MODEL P/N	COMPRESSOR BILL OF MATERIAL	CAPACITY* BTUH	APPLICATION	VOLTS-PHASE	COMPRESSOR P/N	RLA	LRA
60 HZ MODELS							
AGA5546EXN	AG111ET-004-S7Y	46,000	AC/HP	208/230-1	P031-4621	22.7	115.0
AGA5546EXT	AG111RT-004-S7Y	46,700	AC/HP	200/230-3	P031-4651	13.5	93.0
AGA5553EXN	AG122ET-003-S7Y	53,000	AC/HP	208/230-1	P031-5321	26.2	132.0
AGA5553EXT	AG122RT-003-S7Y	53,000	AC/HP	208/230-3	P031-5351	15.5	103.0
AGA5553EXG	AG122UT-003-S7Y	53,000	AC/HP	460-3	P031-5371	7.8	54.0
AGA5553EXH	AG122VT-004-S7Y	53,000	AC/HP	575-3	P031-5381	6.0	30.0
AGA5561EXN	AG133ET-001-S7Y	61,000	AC/HP	208/230-1	P031-6121	35.5	165.0
AGA5561EXT	AG133RT-003-S7Y	61,000	AC/HP	200/230-3	P031-6151	18.0	126.0
AGA5561EXG	AG133UT-003-S7Y	61,000	AC/HP	460-3	P031-6171	9.5	62.0
AGA5561EXH	AG133VT-003-S7Y	61,000	AC/HP	575-3	P031-6181	7.0	39.0
AGA5568EXH	AG144VT-203-S7Y	64,900	AC/HP	575-3	P031-6881	8.2	39.0
AGA5568EXN	AG144ET-002-S7Y	68,000	AC/HP	208/230-1	P031-6821	34.5	179.0
AGA5568EXT	AG144RT-001-S7Y	68,000	AC/HP	200/230-3	P031-6851	20.2	135.0
AGA5568EXG	AG144UT-001-S7Y	68,000	AC/HP	460-3	P031-6871	10.6	70.0
AGA5573EXG	AG188UT-001-S7Y	71,280	AC/HP	460-3	P031-7171	11.8	79.0
50 HZ MODELS 50,700 - 50,800 BTUH							
AG5561E	AG133RT-016-S7Y	50,700	AC/HP	200/230-3	P051-5051	20.5	126.0
AG5561E	AG133UT-016-S7Y	50,800	AC/HP	380/420-3	P051-5071	9.5	62.0

*CAPACITY RATINGS ARE FOR AIR CONDITIONING APPLICATIONS:

Evaporator Temperature 45° F, Condenser Temperature 130° F, Liquid Temperature 115° F, Return Gas Temperature 65° F, Ambient Temperature 95° F.

TECUMSEH HERMETIC COMPRESSORS

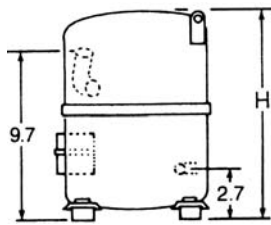

303A

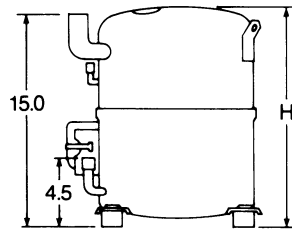

305A

(H) SHELL HEIGHT	SUCT. TUBE I.D.	DISC. TUBE I.D.	MTG. ARR.	COMPR. DWG.	START CAPACITOR		START RELAY P/N	RUN CAPACITOR	
					MFD/VOLTS	P/N		MFD/VOLTS	P/N
15.8	7/8	1/2	A	305A	72-88/330	P281-7206	P283-9924	40/440	P291-4004
15.8	7/8	1/2	A	305A	—	—	—	—	—
16.1	7/8	1/2	A	305A	72-88/330	P281-7206	P283-9924	45/440	P291-4504
16.1	7/8	1/2	A	305A	—	—	—	—	—
16.1	7/8	1/2	A	305A	—	—	—	—	—
15.6	7/8	1/2	A	305A	—	—	—	—	—
16.4	7/8	1/2	A	305A	72-88/330	P281-7206	P283-9924	55/440	P291-5504
15.9	7/8	1/2	A	305A	—	—	—	—	—
15.9	7/8	1/2	A	305A	—	—	—	—	—
15.9	7/8	1/2	A	305A	—	—	—	—	—
16.3	7/8	1/2	A	305A	—	—	—	—	—
16.9	7/8	1/2	A	305A	72-88/330	P281-7206	P283-9924	55/440	P291-5504
16.7	7/8	1/2	A	305A	—	—	—	—	—
16.7	7/8	1/2	A	305A	—	—	—	—	—
16.3	7/8	1/2	A	303A	—	—	—	—	—
15.6	1-1/4	1/2	A	305A	—	—	—	—	—
15.6	1-1/4	1/2	A	305A	—	—	—	—	—

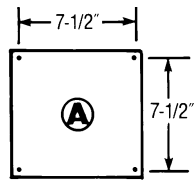

bpa

TECUMSEH HERMETIC COMPRESSORS

TECUMSEH "RG-RK" COMPRESSORS 5,000 - 17,700 BTUH



P26

- ROTARY DESIGN MEANS LOW NOISE & VIBRATION LEVELS
- AIR CONDITIONING & HEAT PUMP APPLICATION
- HIGH EFFICIENCY
- COMPACT DESIGN

COMPRESSOR MODEL P/N	COMPRESSOR BILL OF MATERIAL	CAPACITY BTUH	APPLICATION	VOLTS-PHASE 60 HZ	COMPRESSOR P/N	RLA	LRA
RGA5450EXA	RG100AT-004-S7Y	5,000	AC/HP	115-1	P031-0503	5.0	30.0
RGB5450EXA	309616915 (Frigidaire)	5,050	AC/HP	115-1	P031-0504	4.1	30.7
RGB5460EXA	309616916 (Frigidaire)	6,000	AC/HP	115-1	P031-0604	4.8	31.5
RGB5472EXA	309616919 (Frigidaire)	7,200	AC/HP	115-1	P031-0705	6.4	41.0
RGA5472EXA	RG141AT-002-S7Y	7,200	AC/HP	115-1	P031-0704	6.2	36.2
RGA5472EXD	RG141ET-002	7,250	AC/HP	208/230-1	P032-0722	3.0	17.7
RGA5472EXV	RG141JB-002	7,250	AC/HP	265-1	P031-0792	2.7	15.0
RGA5480EXA	RG150AT-003-S7Y	8,000	AC/HP	115-1	P031-0803	7.0	77.0
RKA5480EXA	RK114AT-001-S7Y	8,100	AC/HP	115-1	P031-0802	6.6	39.2
RKA5490EXD	RK124ET-001-S7Y	9,100	AC/HP	208/230-1	P031-0921	3.8	20.0
RKA5490EXV	RK124JB-001-T7Y	9,100	AC/HP	265-1	P031-0991	3.3	18.6
RKA5490EXA	RK124AT-001-S7Y	9,200	AC/HP	115-1	P031-0901	7.4	44.0
RKA5510EXA	RK136AT-002-S7Y	10,300	AC/HP	115-1	P031-1004	8.6	48.3
RGA5512EXA	RG191AT-005-S7Y	11,500	AC/HP	115-1	P031-1105	10.0	58.4
RGA5512EXD	RG191ET-005-S7Y	11,500	AC/HP	208/230-1	P031-1123	5.5	27.9
RKA5512EXA	RK147AT-002-S7Y	11,700	AC/HP	115-1	P031-1103	9.4	54.0
RKA5512EXD	RK147ET-002-S7Y	11,700	AC/HP	208/230-1	P031-1122	4.4	26.2
RKA5512EXV	RK147JB-002-S7Y	11,700	AC/HP	265-1	P031-1191	4.5	28.0
RKA5513EXA	RK157AT-010-S7Y	13,200	AC/HP	115-1	P031-1301	11.4	67.0
RKA5513EXD	RK157ET-002-T7Y	13,200	AC/HP	208/230-1	P031-1323	5.4	29.0
RKA5513EXV	RK157JB-010-S7Y	13,200	AC/HP	265-1	P031-1391	4.8	27.0
RKA5515EXD	RK222ET-009-S7Y	15,500	AC/HP	208/230-1	P031-1523	6.4	38.0
RKA5515EXV	RK222JB-009-S7Y	15,500	AC/HP	265/277-1	P031-1594	5.4	32.0
RKA5518EXV	RK233JB-009-S7Y	17,500	AC/HP	265-1	P031-1793	6.3	32.0
RKA5518EXD	RK233ET-009-S7Y	17,700	AC/HP	208/230-1	P031-1825	7.6	45.0

*Refer to Base Unit for required Start Capacitor and Relay, if needed.

TECUMSEH HERMETIC COMPRESSORS

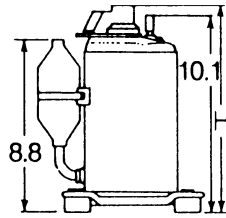

312A

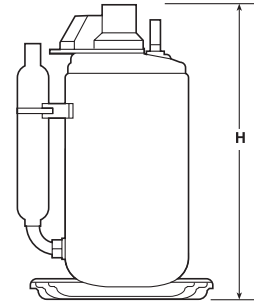

317A

(H) SHELL HEIGHT	SUCT. TUBE I.D.	DISC. TUBE I.D.	MTG. ARR.	COMPR. DWG.	START CAPACITOR		START RELAY P/N	RUN CAPACITOR	
					MFD/VOLTS	P/N		MFD/VOLTS	P/N
10.8	3/8	5/16	P	317A	—	—	—	35/370	P291-3503
10.7	3/8 U	5/16 U	P	317A	—	—	—	—	—
10.7	3/8 U	5/16 U	P	317A	—	—	—	—	—
10.9	3/8 U	5/16 U	P	317A	—	—	—	—	—
11.3	3/8	5/16	P	312A	—	—	—	35/370	P291-3503
11.3	3/8	5/16	P	312A	—	—	—	15/370	P291-1503
11.3	3/8	5/16	P	312A	—	—	—	15/370	P291-1503
11.4	3/8	5/16	P	317A	—	—	—	35/370	P291-3503
10.6	1/2	5/16	S	312A	—	*	*	25/370	P291-2503
10.6	1/2	5/16	S	312A	—	*	*	25/370	P291-2503
11.2	1/2	5/16	S	312A	—	*	*	25/370	P291-2503
11.2	1/2	5/16	S	312A	—	*	*	25/370	P291-2503
10.5	1/2	3/8	S	312A	—	—	—	25/370	P291-2503
11.5	1/2	5/16	—	312A	—	—	—	—	—
11.5	1/2	5/16	P	312A	—	—	—	—	—
11.6	1/2	5/16	S	312A	—	*	*	25/370	P291-2503
10.6	1/2	5/16	S	312A	—	—	—	25/370	P291-2503
11.7	1/2	5/16	S	312A	—	*	*	25/440	P291-2504
11.4	1/2	5/16	S	312A	—	*	*	25/370	P291-2503
11.1	1/2	5/16	S	312A	—	*	*	25/370	P291-2503
12.2	1/2	5/16	S	312A	—	*	*	25/440	P291-2504
11.9	5/8	5/16	S	312A	—	*	*	25/370	P291-2503
32.0	5/8	1/3	S	312A	—	—	—	—	—
32.0	5/8	1/3	S	312A	—	—	—	—	—
11.8	5/8	5/16	S	312A	—	*	*	25/370	P291-2503

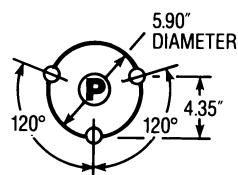

bpp